



## 1803/3 Kings Cross Road RUSHCUTTERS BAY, NSW

1.5 bed | 1 bath | 2 car

**R&W**

- \* Level lift access via elegant lobby with concierge or from security parking
- \* No common walls, stylish contemporary finishes, plenty of natural light
- \* Tandem double car space with secure storage area included
- \* Spacious layout with wall-to-wall glass, refreshing breezes, plenty of light
- \* Open plan living/dining areas, stacking glass doors to full-length balcony

**[rwebay.com.au/1107096](http://rwebay.com.au/1107096)**

Jason Boon 0418 671 494

Geoff Cox 0418 231 004

**Proudly Richardson&Wrench**

Richardson & Wrench Elizabeth Bay / Potts Point  
02 8356 2700

# APARTMENT 1803/3 KINGS CROSS ROAD POTTS POINT

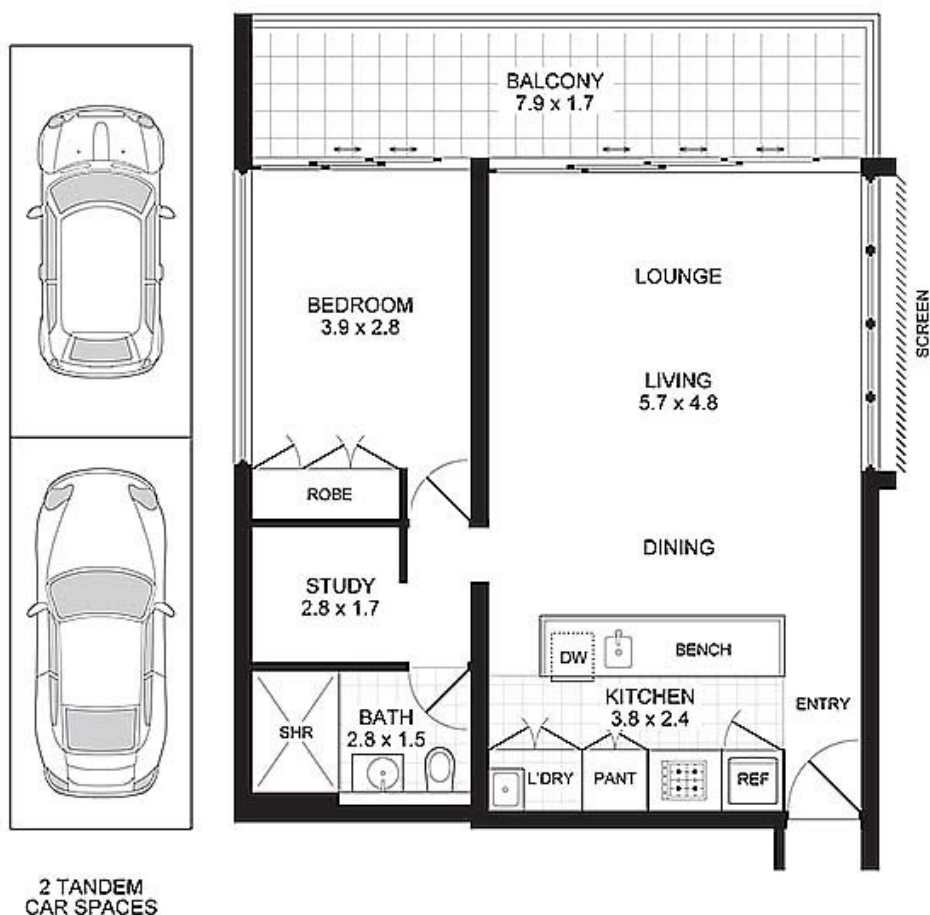

**BASEMENT**

**FLOOR PLAN**

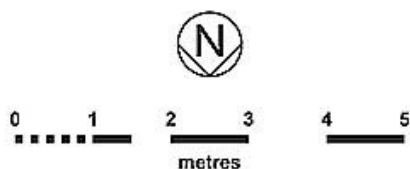

**PROMOPLANS ...adding REAL value!**

E&OE This plan is for illustrative purposes only and dimensions are approximate. It does not constitute part of any legal document or commercial contract for the sale or lease of this property.

COPYRIGHT © 2013 PROMOPLANS 02 9572 7111  
Warning: Usage restricted under the Copyright Act

## Contact

**Jason Boon**  
Phone: 8356 2700 Mobile: 0418 671 494  
Email: jboon@rwebay.com.au

**Geoff Cox**  
Phone: 8356 2734 Mobile: 0418 231 004  
Email: gcox@rwebay.com.au

**R&W**

Elizabeth Bay / Potts Point  
8356 2700