



## 306/33 Bayswater Road POTTS POINT, NSW

1 bed | 1 bath

**R&W**

Ideal investment with attributes rarely found in this price range, this spacious and practical studio apartment located in ???The Crescent??? offers the opportunity for a solid investment, a perfect entry point into the Potts Point market.

Features include: Well proportioned North facing living and lounge leading on to a separate Juliet style balcony with private district outlook elevated high above street level, open plan kitchen, full bathroom with bath, large built in wardrobe, ducted air conditioning and large glass doors with double glazing. Set amongst the buzz of the Potts Point, Darlinghurst l...

[rwebay.com.au/1142585](http://rwebay.com.au/1142585)

Luke McDonnell 0418 844 110

Angelo Bouras 0401 658 653

**Proudly Richardson&Wrench**

Richardson & Wrench Elizabeth Bay / Potts Point  
02 8356 2700

Contact:  
Luke McDonnell  
0418 844 110

Contact:  
Angelo Bouras  
0401 658 653

**R&W** | The best reputation  
in real estate  
Elizabeth Bay/Potts Point

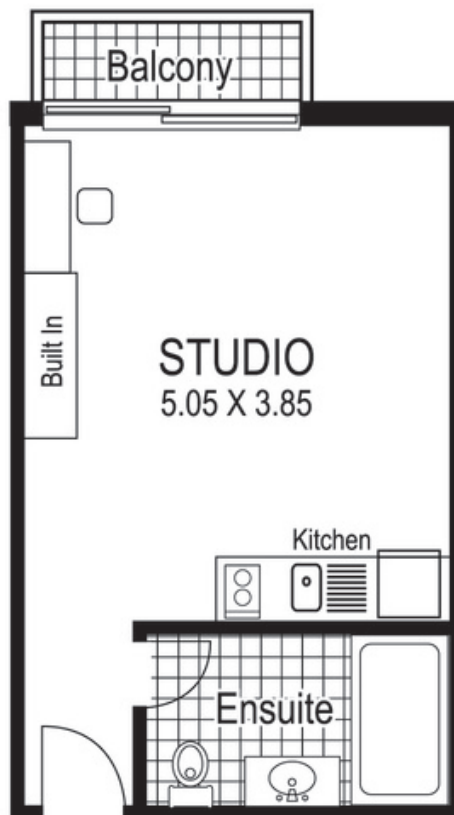

306 / 33 Bayswater Road  
POTTS POINT  
*"CRESCENT"*

Plans shown are for presentation purposes only and are not part of any legal document or title and are subject to errors, omissions, inaccuracies and they should not be used as sole and/or accurate reference for purchasing decision. Interested parties should make their own enquiries using other sources supplied.

© Dimensions shown on plans are approximate values in L x W  
Colour formulas and area coding are subject to copyright  
Illustration by Raoul Isidro 04111 28500

Every precaution has been taken to establish accuracy of the information in this brochure but does not constitute any representation by the vendor or agent.

**R&W**