



## 511/50 Macleay Street POTTS POINT, NSW

1 bed | 1 bath | 1 car

**R&W**

- \* Level access, impressive lobby, 24-hour monitored security
- \* Oversized private landscaped balcony adjoins sitting/sunroom
- \* Additional large open plan living room
- \* Dining area adjoins granite integrated kitchen, Miele appliances
- \* Enormous bedroom, built-ins, glass mosaic bathroom, int laundry
- \* Ducted air con, wall-to-wall glass captures plenty of light and views
- \* Superbly maintained block with indoor heated pool, gy...

**[rwebay.com.au/1467007](http://rwebay.com.au/1467007)**

Geoff Cox 0418 231 004

Jason Boon 0418 671 494

**Proudly Richardson&Wrench**

Richardson & Wrench Elizabeth Bay / Potts Point  
02 8356 2700

# APARTMENT 511/50 MACLEAY STREET POTTS POINT

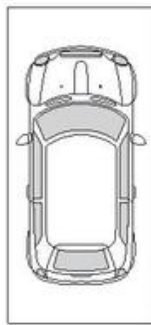

CAR SPACE

**BASEMENT**  
Not to Scale

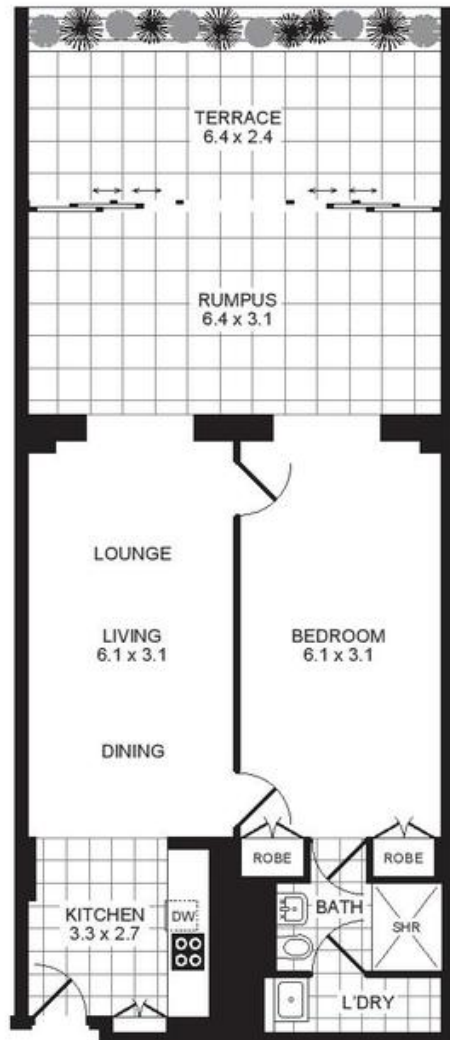

**GROUND FLOOR**  
Scale 1cm = 1m (approx)



## PROMOPLANS ...adding REAL value!

E&OE This plan is for illustrative purposes only and dimensions are approximate. It does not constitute part of any legal document or commercial contract for the sale or lease of this property.

**COPYRIGHT © 2014 PROMOPLANS 02 9572 7111**  
Warning: Usage restricted under the Copyright Act

### Contact

#### Jason Boon

Phone: 8356 2700 Mobile: 0418 671 494  
Email: jboon@rwebay.com.au

#### Geoff Cox

Phone: 8356 2734 Mobile: 0418 231 004  
Email: gcox@rwebay.com.au

# R&W

**Elizabeth Bay | Potts Point**  
**8356 2700**