



1D/6 Macleay Street POTTS POINT, NSW

2 bed | 1 bath | 1 car

R&W

- * Level lift access from the main security lobby or from security parking
- * Central entry hall, 2 double bedrooms, master with built-ins
- * Fully-tiled bathroom with bath, separate shower, internal laundry
- * Spacious open plan living and dining areas extend out to east balcony
- * Good size kitchen with breakfast bar and ample storage
- * Plenty of glass, well proportioned rooms, carpeted floors

rwebay.com.au/1468092

R&W Elizabeth Bay Potts Point
Greg McKinley 0412 044 822

Proudly Richardson&Wrench

Richardson & Wrench Elizabeth Bay / Potts Point
02 8356 2700

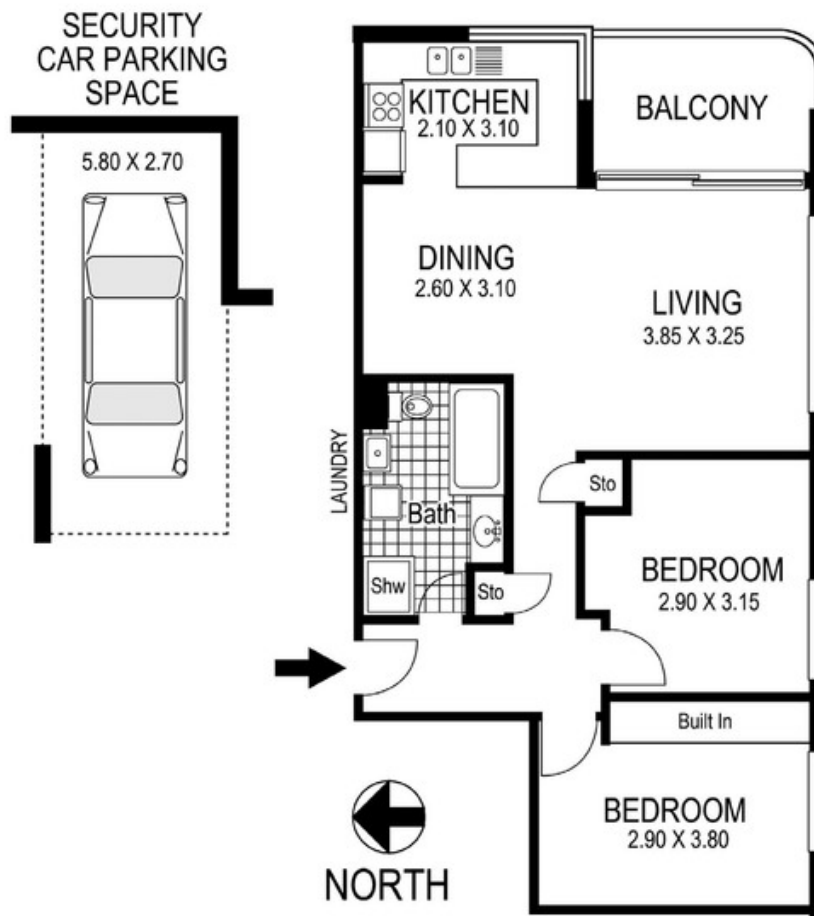

1D / 6 Macleay Street
POTTS POINT

"HARBOURVIEW"

Plans shown are for presentation purposes only and are not part of any legal document or title and are subject to errors, omissions, inaccuracies and they should not be used as sole and/or accurate reference for purchasing decision. Interested parties should make their own enquiries using other sources supplied.