



7/10 Orwell Street POTTS POINT, NSW

1 bed | 1 bath

Completely renovated and located on the 1st floor of a well maintained strata security building, this Art Deco studio apartment is ready to simply take advantage of the strong rental return on offer or a great 1st home/ city pad. With a sleek contemporary kitchen, high ceilings and timber floors this apartment offers the perfect mix of old world charm and modern practicality.

Features include:

An ideal investment or first home the apartment is desi...

R&W

rwebay.com.au/1585479

Luke McDonnell 0418 844 110

Angelo Bouras 0401 658 653

Proudly Richardson&Wrench

Richardson & Wrench Elizabeth Bay / Potts Point
02 8356 2700

APARTMENT 7/10 ORWELL STREET
POTTS POINT

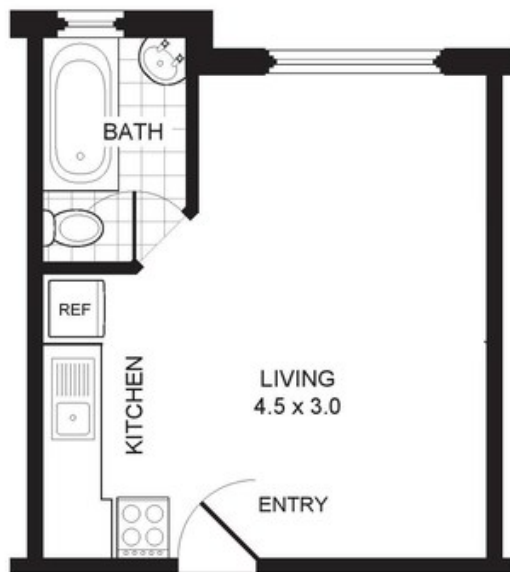

FLOOR PLAN

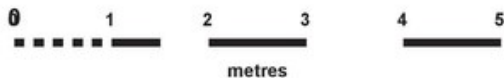

PROMOPLANS ...adding REAL value!

E&CE This plan is for illustrative purposes only and dimensions are approximate. It does not constitute part of any legal document or commercial contract for the sale or lease of this property.

COPYRIGHT © 2012 PROMOPLANS 02 9572 7111
Warning: Usage restricted under the Copyright Act

R&W

Elizabeth Bay / Potts Point
8356 2700