



## 10/21-25 Waratah Street RUSHCUTTERS BAY, NSW

5 bed | 4 bath | 4 car

# R&W

- \* Near-level entry from leafy parkside/harbourside street or level lift access from 4-car security parking
- \* Double height central foyer with Venetian polished stucco feature wall, sweeping stairs to upper floor
- \* Enormous formal living room (with gas fireplace, surround sound) leads out to alfresco private garden
- \* Separate huge open plan family living/dining areas extend out to Northerly deep balcony (gas for bbq)
- \* Granite gas entertaining kitchen, st/steel appliances (2 ovens, 2 full dishwashers) and a walk-in pantry
- \* Marble guest bathroom, separate internal laundry/util...

[rwebay.com.au/1608680](http://rwebay.com.au/1608680)

Jason Boon 0418 671 494

Geoff Cox 0418 231 004

**Proudly Richardson&Wrench**

Richardson & Wrench Elizabeth Bay / Potts Point  
02 8356 2700

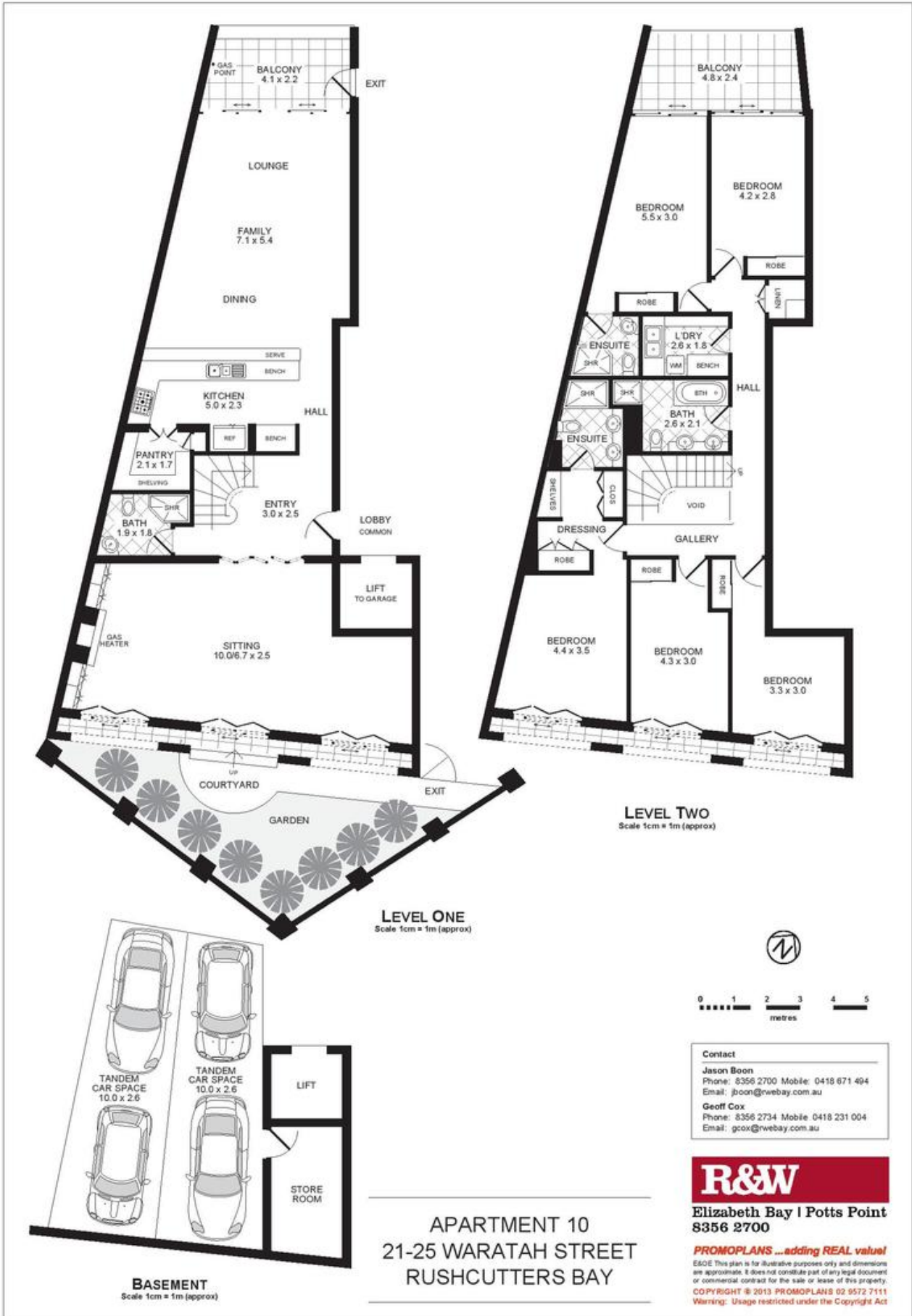

Every precaution has been taken to establish accuracy of the information in this brochure but does not constitute any representation by the vendor or agent.

