



## 1/8 Rockwall Crescent POTTS POINT, NSW

1 bed | 1 bath | 1 car

**R&W**

- \* Almost hidden from the picturesque cul de sac setting
- \* Private entrance area
- \* Spacious living room with a bay fronted study area and French doors to leafy private courtyard garden
- \* Open plan dining zone adjoins the galley kitchen with electric hob, rangehood, oven, built-in storage
- \* Double bedroom, neat bathroom, internal laundry facility
- \* Well-proportioned layout, carpeted floors, loads of character
- \* Valuable security parking space (via rear lane), easy level access to apartment via common hallway
- \* Let your creative flair add value to this rare city p...

[rwebay.com.au/1778640](http://rwebay.com.au/1778640)

Jason Boon 0418 671 494

Geoff Cox 0418 231 004

**Proudly Richardson&Wrench**

Richardson & Wrench Elizabeth Bay / Potts Point  
02 8356 2700



NORTH

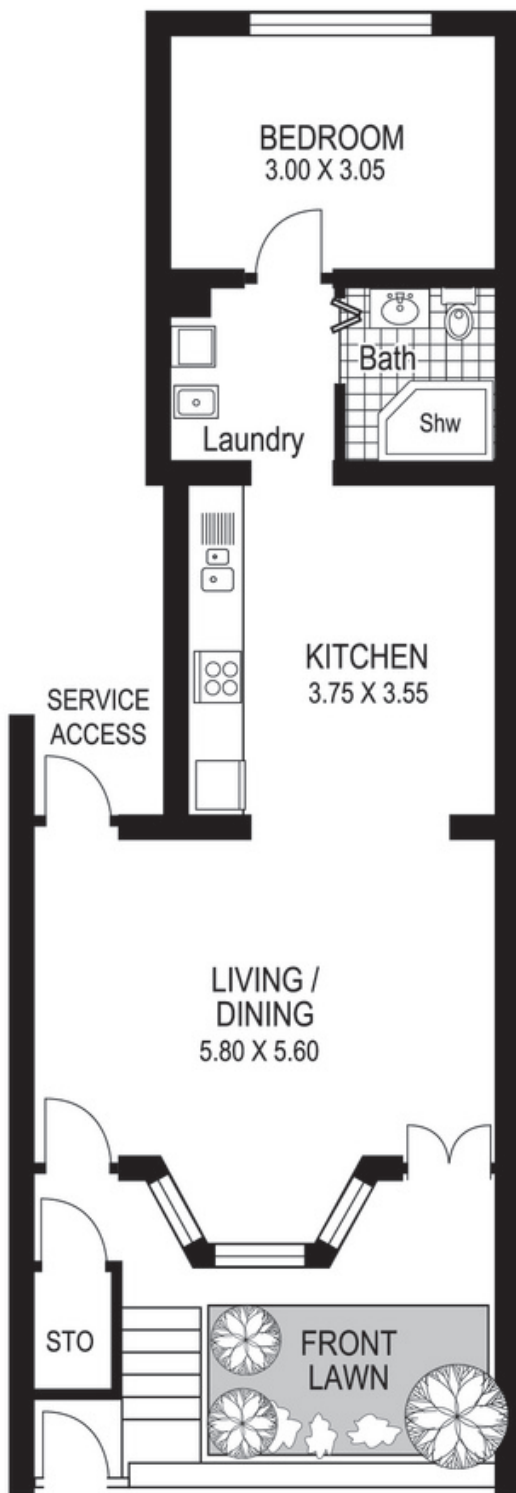

Contact:  
Jason Boon  
0418 671 494

Contact:  
Geoff Cox  
0418 231 004

Plans shown are for presentation purposes only and are not part of any legal document or title and are subject to errors, omissions, inaccuracies and they should not be used as sole and/or accurate reference for purchasing decision. Interested parties should make their own enquiries using other sources supplied. Dimensions shown on the plans are approximate values in length by width. Illustration by Raoul Isidro 04111 28500.



1 / 6-8 Rockwall Crescent  
POTTS POINT