



## 515/33 Bronte Road BONDJ JUNCTION, NSW

1 bed | 1 bath | 1 car

Genoa is Bondi Junctions most conveniently located and highly sought-after residential developments.

This one bedroom apartment (approx 69sqm including balcony) features spacious living area, ample built-in storage, internal laundry and modern, easy-to-maintain kitchen. The full length enclosed balcony is a welcome addition giving the astute purchaser an additional living area. This apartment also comes with a security car space.

???Genoa??? also boasts high-end facilities such as on-...

# R&W

[rwebay.com.au/1800708](http://rwebay.com.au/1800708)

R&W Elizabeth Bay Potts Point  
Andrew Hoggett 0412 208 614

**Proudly Richardson&Wrench**

Richardson & Wrench Elizabeth Bay / Potts Point  
02 8356 2700

Contact:  
Nicholas Tsaoucis  
0419 777 717

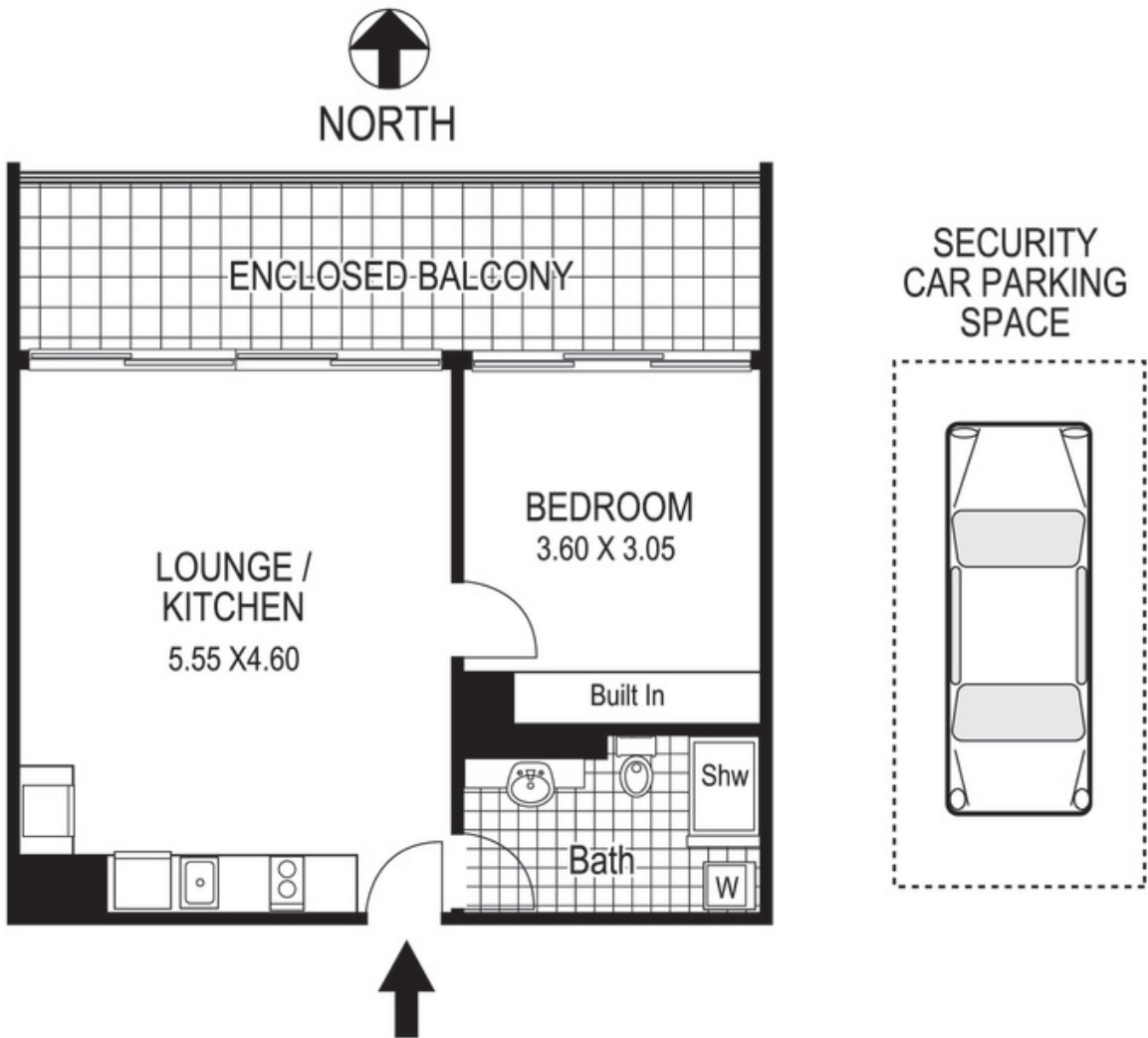

## 515 / 33-35 Bronte Road BONDI JUNCTION

Plans shown are for presentation purposes only and are not part of any legal document or title and are subject to errors, omissions, inaccuracies and they should not be used as sole and/or accurate reference for purchasing decision. Interested parties should make their own enquiries using other sources supplied. Dimensions shown on the plans are approximate values in length by width. Illustration by Raoul Isidro 04111 28500.

Every precaution has been taken to establish accuracy of the information in this brochure but does not constitute any representation by the vendor or agent.