



6/11 Wylde Street POTTS POINT, NSW

1.5 bed | 1 bath

- * Near level entrance via classic paneled security lobby
- * Central private foyer, open plan living and dining room
- * Impressive fully tiled bathroom with internal laundry facility
- * Granite designer kitchen with st/steel gas hob, rangehood, oven, microwave, Blanco dishwasher
- * Oversized bedroom with entire wall of quality built-in wardrobes
- * Balcony-style separate sunroom or study with built-in daybed, storage areas, plantation shutters and bonus harbour cameos

R&W

rwebay.com.au/1990337

Luke McDonnell 0418 844 110

Angelo Bouras 0401 658 653

Jason Boon 0418 671 494

Proudly Richardson&Wrench

Richardson & Wrench Elizabeth Bay / Potts Point
02 8356 2700

R&W | The best reputation
in real estate
Elizabeth Bay/Potts Point

Contact:
Luke McDonnell
0418 844 110

Contact:
Jason Boon
0418 671 494

Contact:
Angelo Bouras
0401 658 653

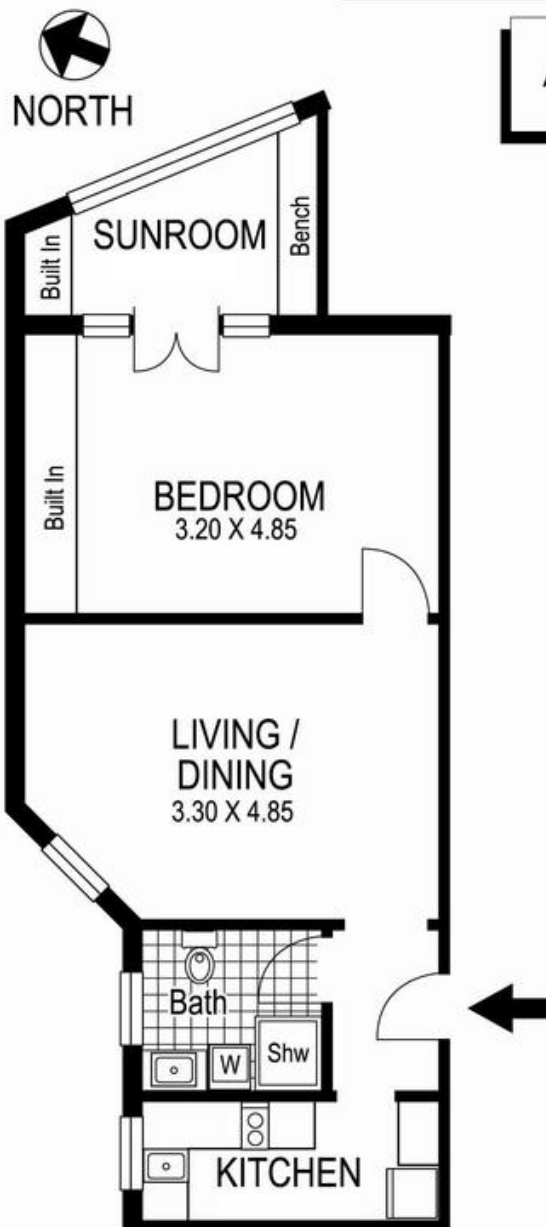

6 /11 Wylde Street POTTS POINT

Plans shown are for presentation purposes only and are not part of any legal document or title and are subject to errors, omissions, inaccuracies and they should not be used as sole and/or accurate reference for purchasing decision. Interested parties should make their own enquiries using other sources supplied. Dimensions shown on the plans are approximate values in length by width. Illustration by Raoul Isidro. 04111 28500.

Every precaution has been taken to establish accuracy of the information in this brochure but does not constitute any representation by the vendor or agent.

R&W