



6/11 Wylde Street POTTS POINT, NSW

1 bed | 1 bath

Blissfully quiet and featuring a total refurbishment of exceptionally good taste, this bright and spacious one bedroom plus sun room apartment is an ideal city pad.

Meticulously rebuilt for elegant classic contemporary living with minimal upkeep, this superb apartment occupies a prime north-west corner wing position in a tightly held gracious Art Deco security block of 16.

A short walk to Woolloomooloo Bay and Sydney CBD, this ...

R&W

rwebay.com.au/2087926

R&W Leasing 02 8356 2700

Joss Reid 0414 662 391

Proudly Richardson&Wrench

Richardson & Wrench Elizabeth Bay / Potts Point
02 8356 2700

R&W | The best reputation
in real estate
Elizabeth Bay / Potts Point

Contact:
Luke McDonnell
0418 844 110

Contact:
Jason Boon
0418 671 494

Contact:
Angelo Bouras
0401 658 653

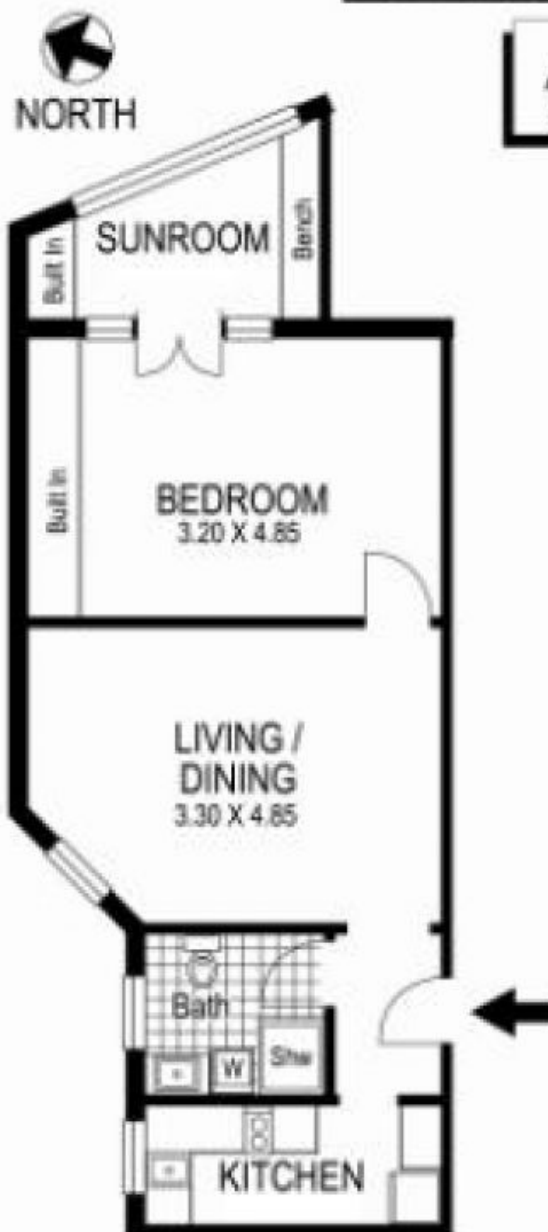

**6 /11 Wylde Street
POTTS POINT**

Plans shown are for presentation purposes only and are not part of any legal document or title and are subject to errors, omissions, inaccuracies and they should not be used as sole and/or accurate reference for purchasing decision. Interested parties should make their own enquiries using other sources supplied. Dimensions shown on the plans are approximate values in length by width. Illustration by R&W Ltd 04111 28900.

Every precaution has been taken to establish accuracy of the information in this brochure but does not constitute any representation by the vendor or agent.

R&W