



512/63 Crown Street Woolloomooloo, NSW

1 bed | 1 bath | 1 car

R&W

Facing north-east and enjoying harbour and district views, this spacious 81sqm apartment is conveniently positioned in the Crown Gardens security complex and just 10 minutes' walk to the CBD, harbour and some of Sydney's best entertainment venues. It features a large double bedroom with built-in robes, internal laundry, large full-sized granite bathroom with deep bathtub and open plan granite kitchen with gas cooking. A light-filled living room opens to a generous balcony, with features such as ducted reverse airconditioning, ample storage space and undercover security carspace with visitor parking. The building also has concierge, pool, sauna, gym and barbeque area.

rwebay.com.au/2896670

R&W Leasing 02 8356 2700

Proudly Richardson&Wrench

Richardson & Wrench Elizabeth Bay / Potts Point
02 8356 2700

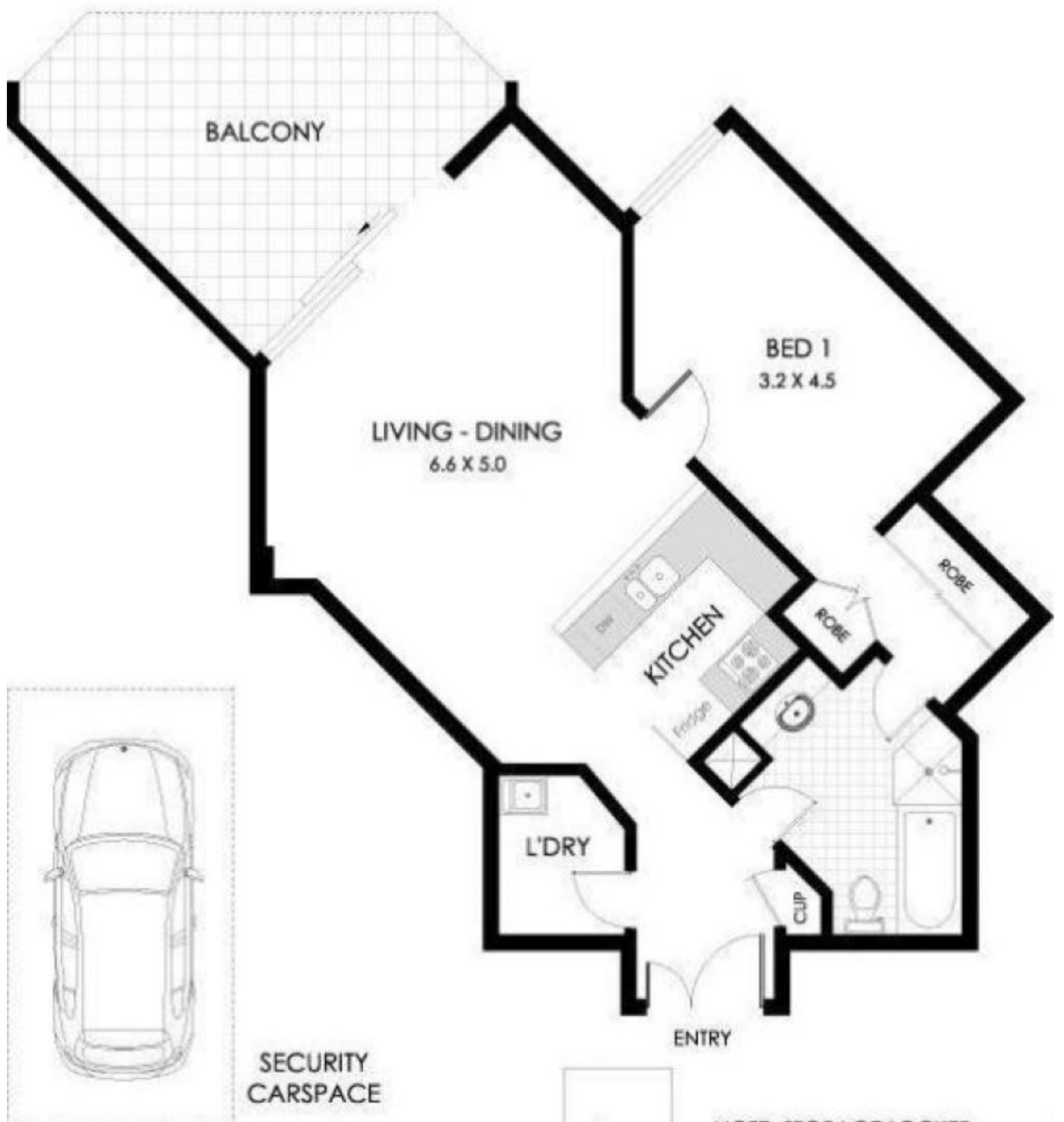

Every precaution has been taken to establish accuracy of the information in this brochure but does not constitute any representation by the vendor or agent.