



1/12 Rockwall Crescent POTTS POINT, NSW

2 bed | 2 bath | 1 car

R&W

Set in the historic Knightsbridge, part of a suite of grand terrace houses, this spacious two-bedroom (possible 3rd bedroom), two-storey home offers a cosy abode on one of Potts Point's most tightly-held streets. With scope to improve, this north-facing home is ripe for renovation, its 184sqm offering an exciting canvas on which to create your dream sanctuary, complete with private carspace and sunny courtyard.

Built in the late 1800s in the neo-classical style, the...

rwebay.com.au/2916807

Luke McDonnell 0418 844 110

Jason Boon 0418 671 494

Proudly Richardson&Wrench

Richardson & Wrench Elizabeth Bay / Potts Point
02 8356 2700

Rockwall Lane

Roll Up Door

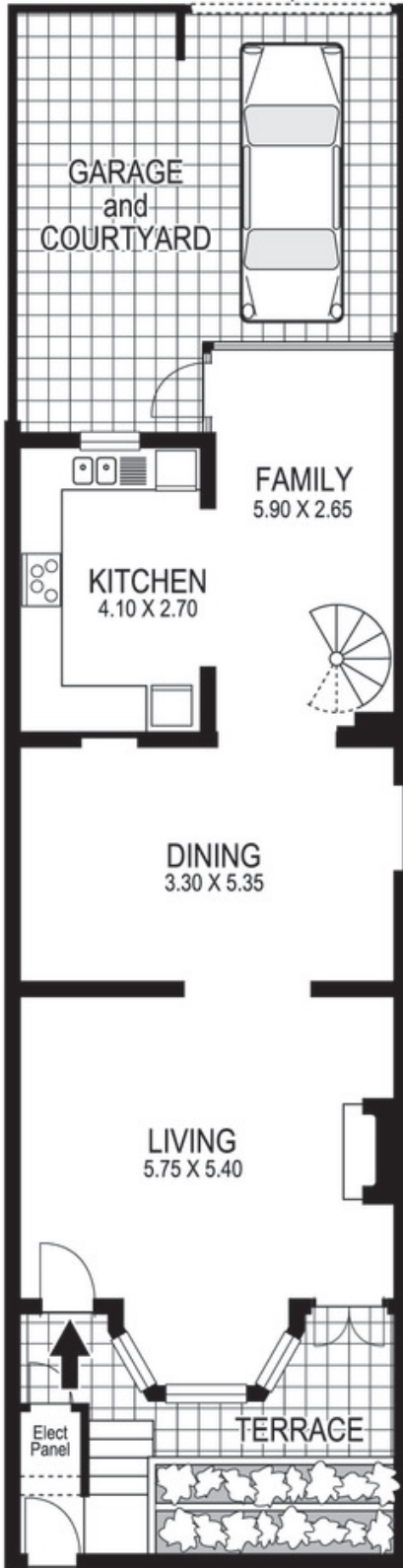

Ground Floor

R&W | The best reputation
in real estate
Elizabeth Bay/Potts Point

Contact:
Luke McDonnell
0418 844 110



Upper Level

Rockwall Crescent

1 / 12 Rockwall Crescent
POTTS POINT

Plans shown are for presentation purposes only and are not part of any legal document or title and are subject to errors, omissions, inaccuracies and they should not be used as sole and/or accurate reference for purchasing decision. Interested parties should make their own enquiries using other sources supplied. Dimensions shown on the plans are approximate values in length by width. Illustration by Raoul Isidro 04111 28500.

Every precaution has been taken to establish accuracy of the information in this brochure but does not constitute any representation by the vendor or agent.

