



206/50 Macleay Street POTTS POINT, NSW

1 bed | 1 bath | 1 car

R&W

- * Vast living/dining room with plush carpet
- * Generous outdoor entertaining terrace
- * Open plan kitchen with stone bench tops
- * Stainless steel Miele cooking appliances
- * Huge bedroom with built-in and ensuite
- * Bedroom also enjoys access to terrace
- * Chic bathroom, frameless glass shower
- * Ducted air conditioning, internal laundry
- * Secure underground parking space

rwebay.com.au/3550414

Luke McDonnell 0418 844 110

Angelo Bouras 0401 658 653

Proudly Richardson&Wrench

Richardson & Wrench Elizabeth Bay / Potts Point
02 8356 2700

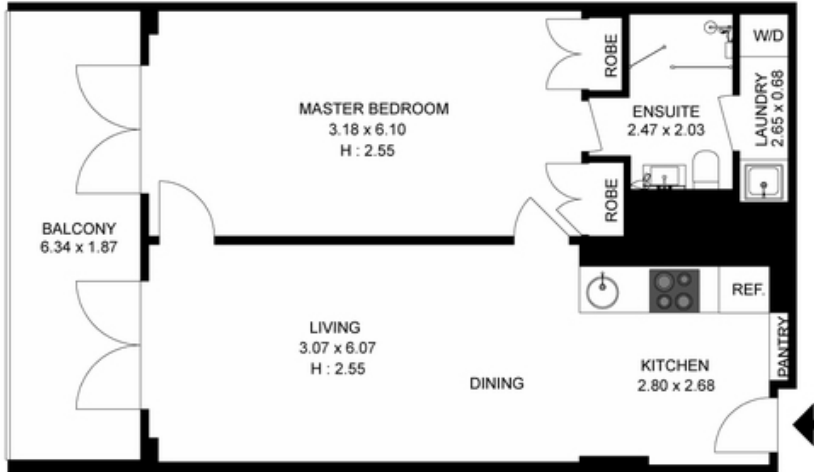

206/50 MACLEAY STREET, POTTS POINT

Plans shown are for presentation purposes and are not part of any legal document or title. They are subject to errors and inaccuracies and should not be used as the sole reference for purchasing decision. Measurements are indicative and in meters.

Produced by DIAKRIT

Every precaution has been taken to establish accuracy of the information in this brochure but does not constitute any representation by the vendor or agent.

