



31/67 Macleay Street Potts Point, NSW

1 bed | 1 bath

Step out to Harbour Bridge and city skyline views from this top floor security apartment that features contemporary finishes. It offers a chic city fringe haven in a great location moments to the Woolloomooloo waterfront, village cafes, restaurants and nightlife.

Features include:

- Light filled living area flows through to a main balcony
- Views of the city skyline including the Harbour Bridge
- Modern and well equipped galley-style kitchen

R&W

rwebay.com.au/3787687

R&W Leasing 02 8356 2700

Proudly Richardson&Wrench

Richardson & Wrench Elizabeth Bay / Potts Point
02 8356 2700

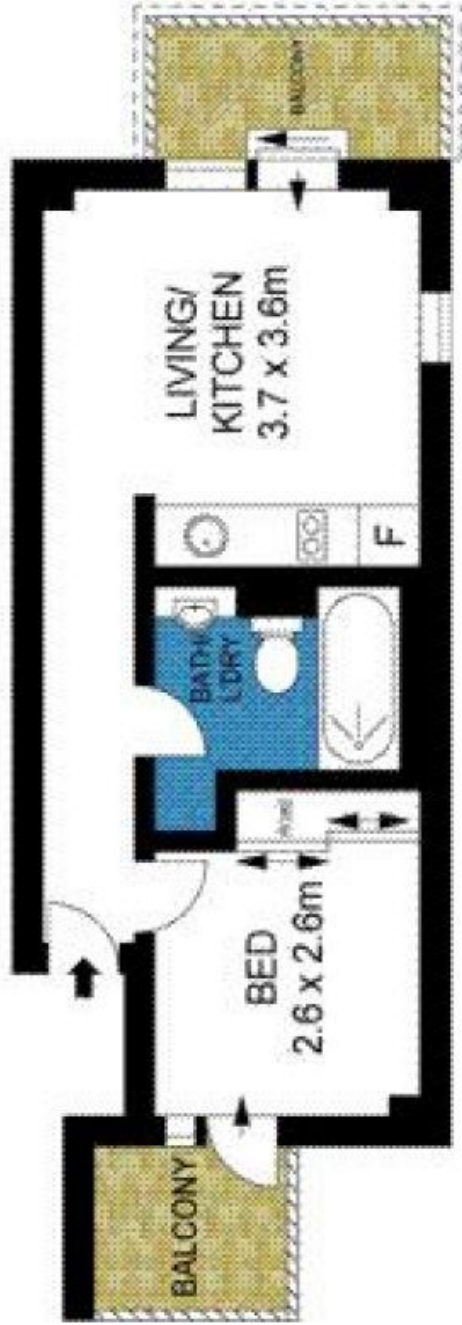

LEVEL FIVE

