



511/50 Macleay Street POTTS POINT, NSW

1 bed | 1 bath | 1 car

R&W

- * Level access, impressive lobby, 24-hour monitored security
- * Oversized private landscaped balcony adjoins sitting/sunroom
- * Additional large open plan living room
- * Dining area adjoins granite integrated kitchen, Miele appliances
- * Enormous bedroom, built-ins, glass mosaic bathroom, int laundry
- * Ducted air con, wall-to-wall glass captures plenty of light and views
- * Superbly maintained block with indoor heated pool, gy...

rwebay.com.au/1467007

Geoff Cox 0418 231 004

Jason Boon 0418 671 494

Proudly Richardson&Wrench

Richardson & Wrench Elizabeth Bay / Potts Point
02 8356 2700

APARTMENT 511/50 MACLEAY STREET POTTS POINT

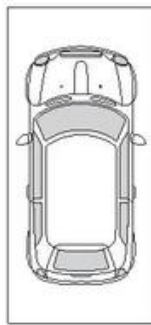

CAR SPACE

BASEMENT
Not to Scale

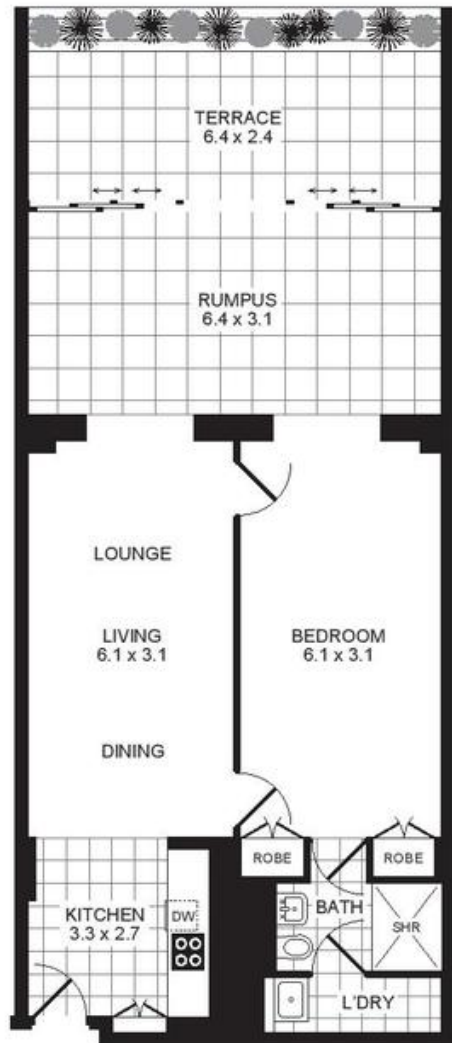

GROUND FLOOR
Scale 1cm = 1m (approx)



Contact

Jason Boon
Phone: 8356 2700 Mobile: 0418 671 494
Email: jboon@rwebay.com.au

Geoff Cox
Phone: 8356 2734 Mobile: 0418 231 004
Email: gcox@rwebay.com.au

PROMOPLANS ...adding REAL value!

E&OE This plan is for illustrative purposes only and dimensions are approximate. It does not constitute part of any legal document or commercial contract for the sale or lease of this property.

COPYRIGHT © 2014 PROMOPLANS 02 9572 7111
Warning: Usage restricted under the Copyright Act

R&W

Elizabeth Bay | Potts Point
8356 2700