



## 4/3 Waratah Street RUSHCUTTERS BAY, NSW

1 bed | 1 bath

Exuding the character and charm for which the Art Deco period is renowned, this exceptional residence is conveniently placed in one of Rushcutters Bay's most sought-after enclaves. 'Park Entrance', a boutique block of 6, it is literally footsteps to magnificent harbour side parklands, playing fields, cafés and local tennis courts

. Period features throughout, fully renovated bathroom with modern touches

This apartment represents a great opportunity for the a...

# R&W

[rwebay.com.au/1710907](http://rwebay.com.au/1710907)

R&W Elizabeth Bay Potts Point

**Proudly Richardson&Wrench**

Richardson & Wrench Elizabeth Bay / Potts Point  
02 8356 2700

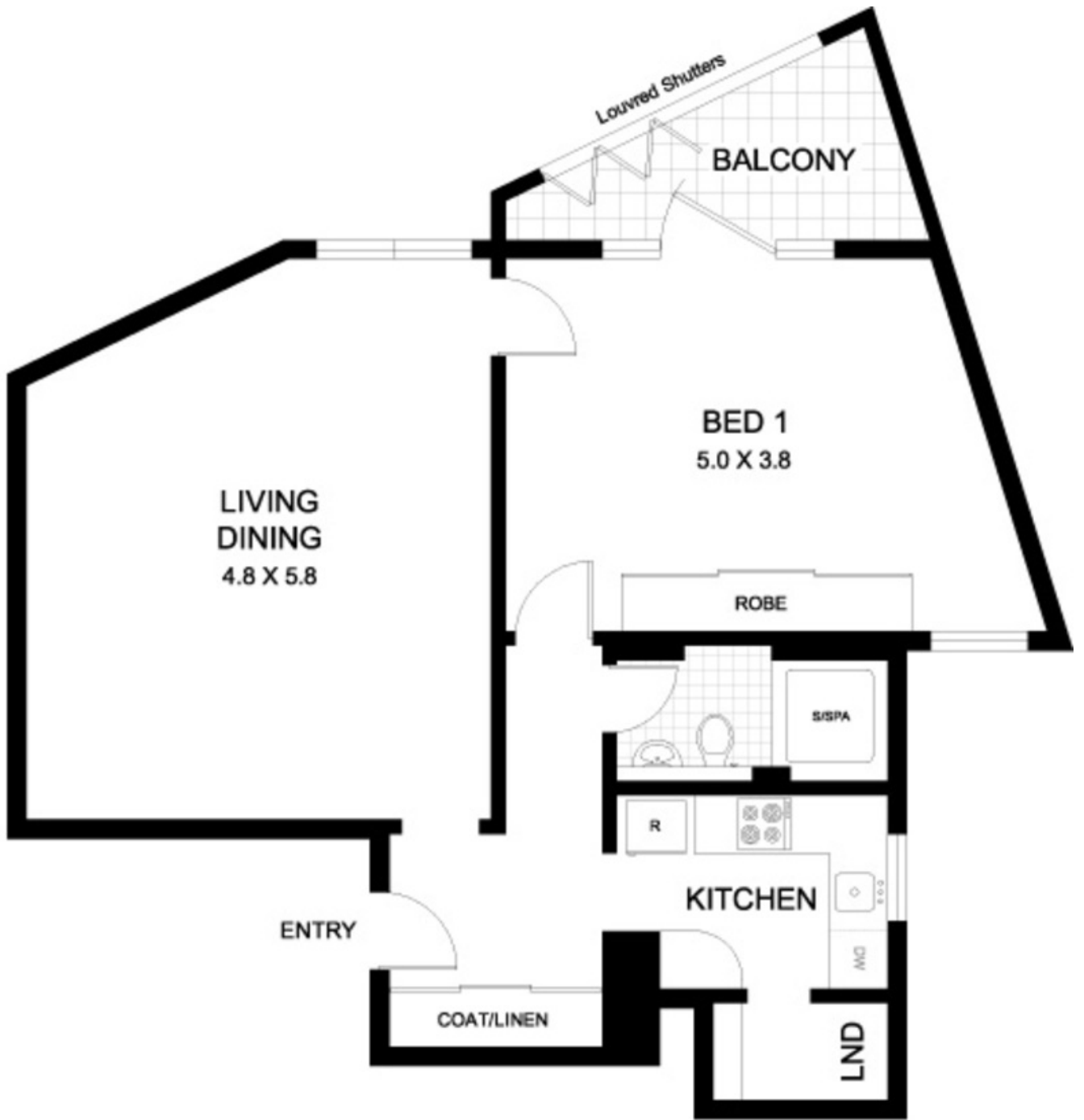

4/3 WARATAH STREET

RUSHCUTTERS BAY

PLANS SHOWN ARE ONLY INDICATIVE OF LAYOUT. DIMENSIONS ARE APPROXIMATE. 0 1 3 SCALE BAR in metres

METRO FLOORPLANS  
0418 223 433

Every precaution has been taken to establish accuracy of the information in this brochure but does not constitute any representation by the vendor or agent.

**R&W**