



1/8 Rockwall Crescent POTTS POINT, NSW

1 bed | 1 bath | 1 car

R&W

- * Almost hidden from the picturesque cul de sac setting
- * Private entrance area
- * Spacious living room with a bay fronted study area and French doors to leafy private courtyard garden
- * Open plan dining zone adjoins the galley kitchen with electric hob, rangehood, oven, built-in storage
- * Double bedroom, neat bathroom, internal laundry facility
- * Well-proportioned layout, carpeted floors, loads of character
- * Valuable security parking space (via rear lane), easy level access to apartment via common hallway
- * Let your creative flair add value to this rare city p...

rwebay.com.au/1778640

Jason Boon 0418 671 494

Geoff Cox 0418 231 004

Proudly Richardson&Wrench

Richardson & Wrench Elizabeth Bay / Potts Point
02 8356 2700



NORTH

Contact:
Jason Boon
0418 671 494

Contact:
Geoff Cox
0418 231 004

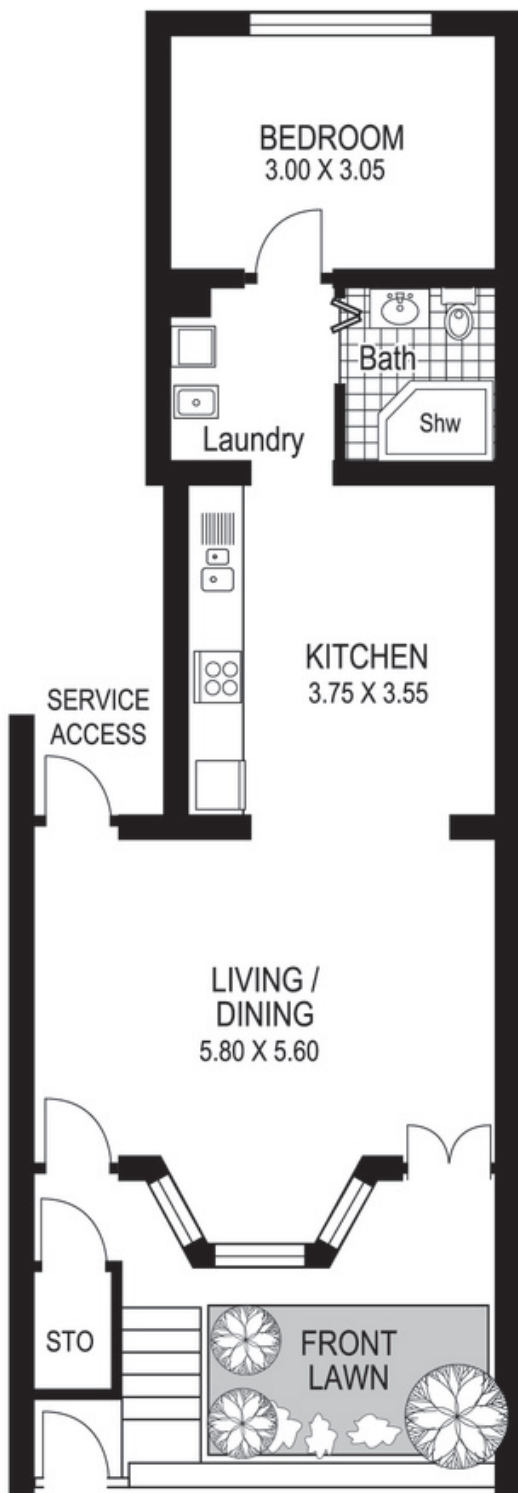

Plans shown are for presentation purposes only and are not part of any legal document or title and are subject to errors, omissions, inaccuracies and they should not be used as sole and/or accurate reference for purchasing decision. Interested parties should make their own enquiries using other sources supplied. Dimensions shown on the plans are approximate values in length by width. Illustration by Raoul Isidro 04111 28500.

1 / 6-8 Rockwall Crescent
POTTS POINT