



1/18 Macleay Street POTTS POINT, NSW

2 bed | 2 bath | 1 car

Offering quiet privacy and a spacious layout for classic contemporary luxury living, this elegant pied-a-terre occupies a rear wing position in Villard, one of this cool cosmopolitan locale's most prestigious modern security buildings. Designed by the acclaimed architect Ercole Palazzetti and inspired by the grandeur of New York or Paris, you'll be impressed by this tightly-held boutique building and the ultra-convenient location. With the buzz and lifestyle of cafes, restaurants, shops, transport and parks just metres from the door, this impeccable apartment is perfect for those scaling down or trading up.

...

R&W

rwebay.com.au/2022914

Jason Boon 0418 671 494

Geoff Cox 0418 231 004

Proudly Richardson&Wrench

Richardson & Wrench Elizabeth Bay / Potts Point
02 8356 2700

R&W | The best reputation
in real estate
Elizabeth Bay/Potts Point

Contact:
Jason Boon
0418 671 494

Contact:
Geoff Cox
0418 231 004

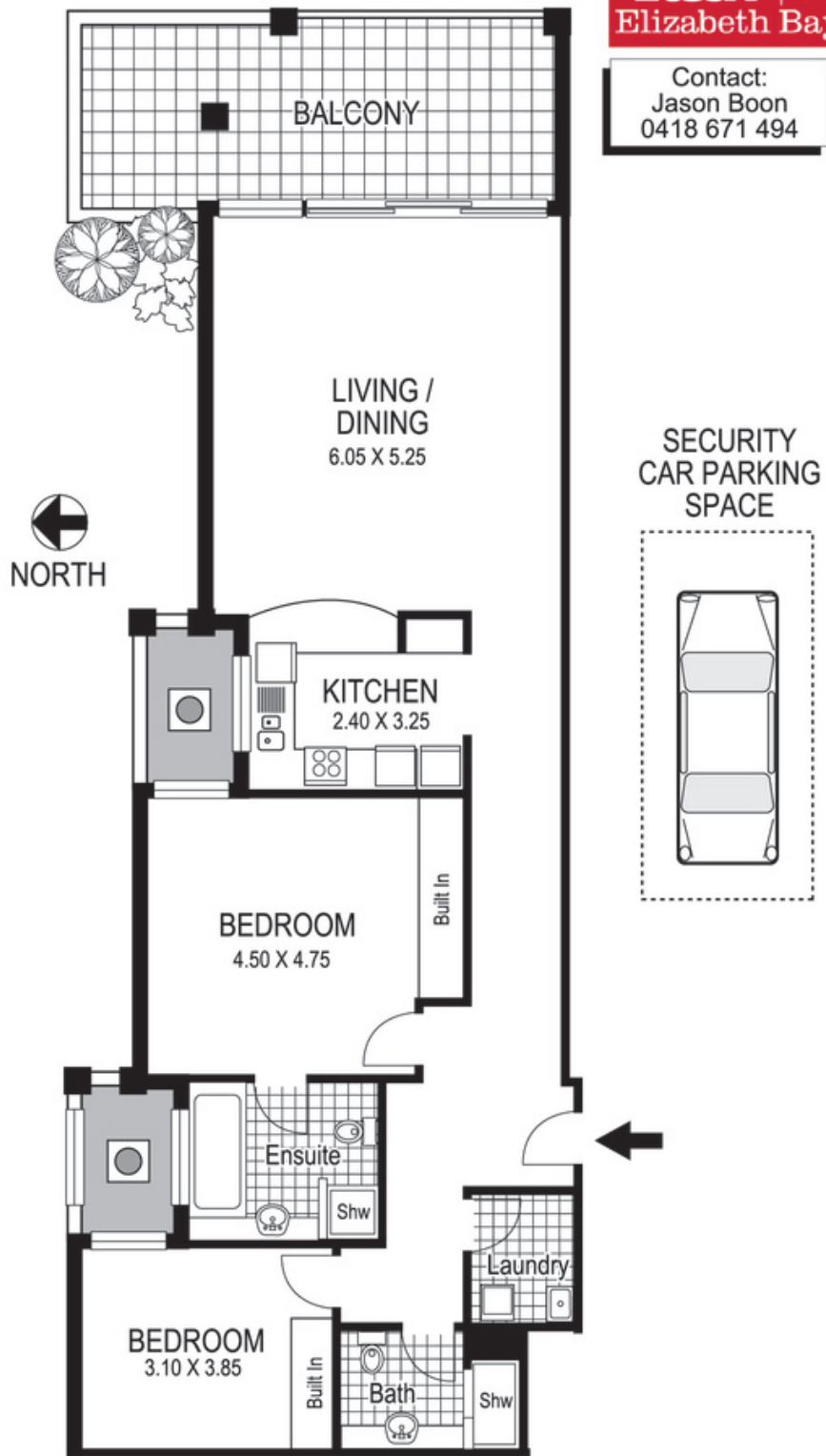

1 / 18 Macleay Street POTTS POINT

Plans shown are for presentation purposes only and are not part of any legal document or title and are subject to errors, omissions, inaccuracies and they should not be used as sole and/or accurate reference for purchasing decision. Interested parties should make their own enquiries using other sources supplied. Dimensions shown on the plans are approximate values in length by width. Illustration by Raoul Isidro 04111 28500.

Every precaution has been taken to establish accuracy of the information in this brochure but does not constitute any representation by the vendor or agent.

