



1/8 Rockwall Crescent POTTS POINT, NSW

1 bed | 1 bath | 1 car

R&W

One of only three apartments within a converted grand c.1890 Victorian terrace-house, this lower level garden apartment has been newly renovated and is located in the heart of fashionable Potts Point. Featuring a private entry area and a leafy low maintenance private courtyard garden, creating a house-like feel. The property has been freshly renovated with stunning timber floors, brand new kitchen with dishwasher, with updated bathroom and newly carpeted bedroom. Quiet and private yet just footsteps to cafes, delis, boutiques, supermarkets, parks and transport choices.

- Spacious living room with a bay fronted study area an...

rwebay.com.au/2186678

R&W Leasing 02 8356 2700

Proudly Richardson&Wrench

Richardson & Wrench Elizabeth Bay / Potts Point
02 8356 2700



NORTH

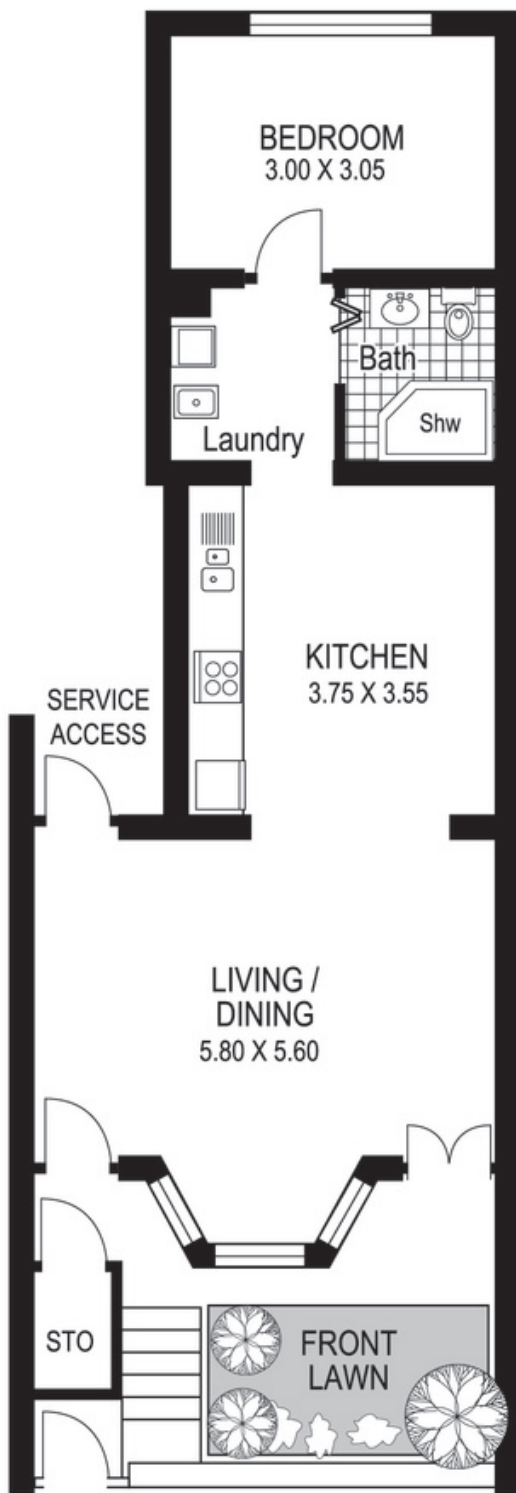

Contact:
Jason Boon
0418 671 494

Contact:
Geoff Cox
0418 231 004

Plans shown are for presentation purposes only and are not part of any legal document or title and are subject to errors, omissions, inaccuracies and they should not be used as sole and/or accurate reference for purchasing decision. Interested parties should make their own enquiries using other sources supplied. Dimensions shown on the plans are approximate values in length by width. Illustration by Raoul Isidro 04111 28500.

1 / 6-8 Rockwall Crescent
POTTS POINT