



## 11/7 Ithaca Road ELIZABETH BAY, NSW

1 bed | 1 bath

You will know that you've found something special the moment you walk through the front door. This immaculate, over sized top floor one bedroom home located within a stunning tree lined setting boasting a serene outlook.

Features include:

- Generous floor plan with stunning period details.
- Elongated entry hall leading into perfectly proportioned open plan living
- One bedroom plus designated study area

# R&W

[rwebay.com.au/2638144](http://rwebay.com.au/2638144)

R&W Leasing 02 8356 2700

**Proudly Richardson&Wrench**

Richardson & Wrench Elizabeth Bay / Potts Point  
02 8356 2700

APARTMENT 11/7 ITHACA ROAD  
ELIZABETH BAY

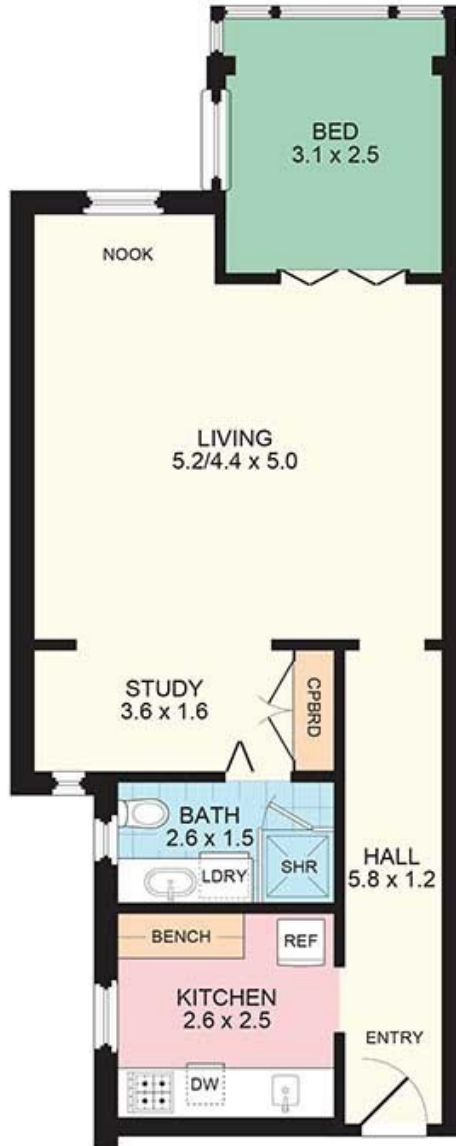

FLOOR PLAN

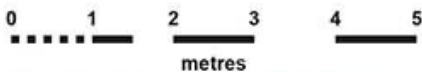

**PROMOPLANS ...adding REAL value!**

E&OE This plan is for illustrative purposes only and dimensions are approximate. It does not constitute part of any legal document or commercial contract for the sale or lease of this property.

COPYRIGHT © 2015 PROMOPLANS 02 9572 7111

CONTACT:

John Hoggett  
Phone 8356 2700 Mobile 0431 411 004  
Email [jhoggett@rwebay.com.au](mailto:jhoggett@rwebay.com.au)

**R&W**

Elizabeth Bay | Potts Point  
8356 2700