



## 140 Victoria Street POTTS POINT, NSW

3 bed | 4 bath

# R&W

- \* Huge opportunity for remodelling into contemporary home
- \* Zoned mixed use. Massive scope for use as business or dining premises
- \* Exciting development prospect (STCA)
- \* Excellent street frontage with unique private garden entrance
- \* Character living spaces with original floorboards and features
- \* Dual access from Victoria St and Earl St
- \* Expansive floorplan set over 3 large levels
- \* 360-degree rooftop views over district to CBD

[rwebay.com.au/3707119](http://rwebay.com.au/3707119)

Jason Boon 0418 671 494

Geoff Cox 0418 231 004

**Proudly Richardson&Wrench**

Richardson & Wrench Elizabeth Bay / Potts Point  
02 8356 2700

EARL STREET ENTRY

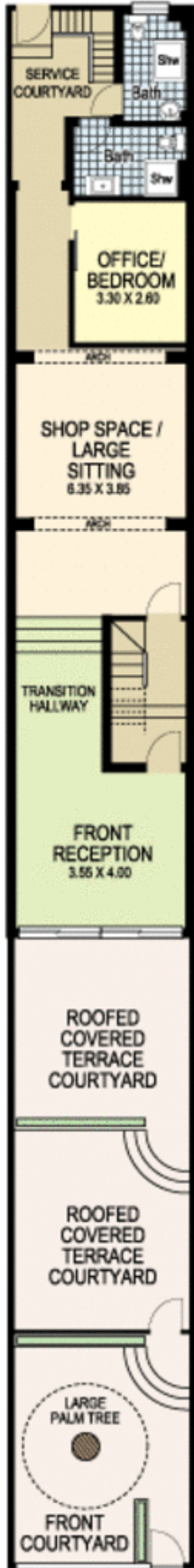

Ground Floor



First Floor

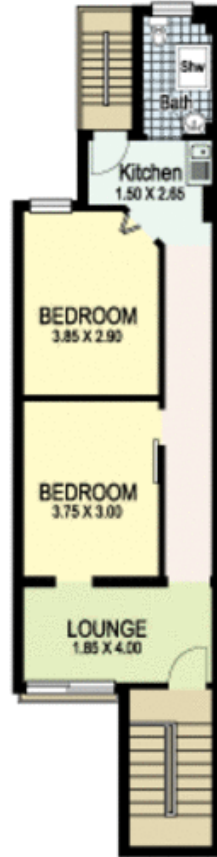

Second Floor

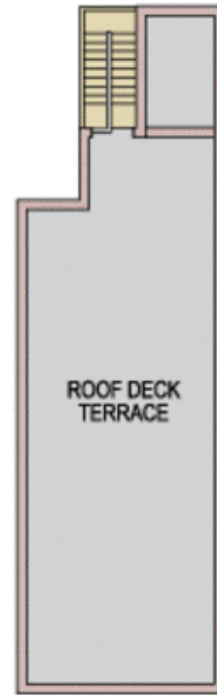

Roof Deck



NORTH

# 140 Victoria Street POTTS POINT



Elizabeth Bay / Potts Point  
8356 2700

Plans shown are for presentation purposes only and are not part of any legal document or file and are subject to errors, omissions, inaccuracies and they should not be used as the sole and/or accurate reference for purchasing decision. Interested parties should make their own inquiries using other sources supplied. Dimensions in length and width are approximate. Illustration by Robert Ishino 0411125500

