



## 1109/18-20 Pelican Street SURRY HILLS, NSW

2 bed | 2 bath | 1 car

**R&W**

- \* Fantastic elevated space, sweeping views to the south
- \* Secure undercover parking with direct lift access, and two separate storage cages
- \* Air-conditioning with central control throughout
- \* Stylish corner balcony with extensive district views
- \* Kitchen with integrated Miele appliances, stone benches
- \* Main bedroom with walk-in robe, full en-suite
- \* 2nd bedroom with b/ins, easterly views from both bedrooms
- \* Acclaimed security building with concierge
- \* Building with high quality gym, pool and outdoor ente...

[rwebay.com.au/3745067](http://rwebay.com.au/3745067)

Geoff Cox 0418 231 004

Angelo Bouras 0401 658 653

Jason Boon 0418 671 494

**Proudly Richardson&Wrench**

Richardson & Wrench Elizabeth Bay / Potts Point  
02 8356 2700

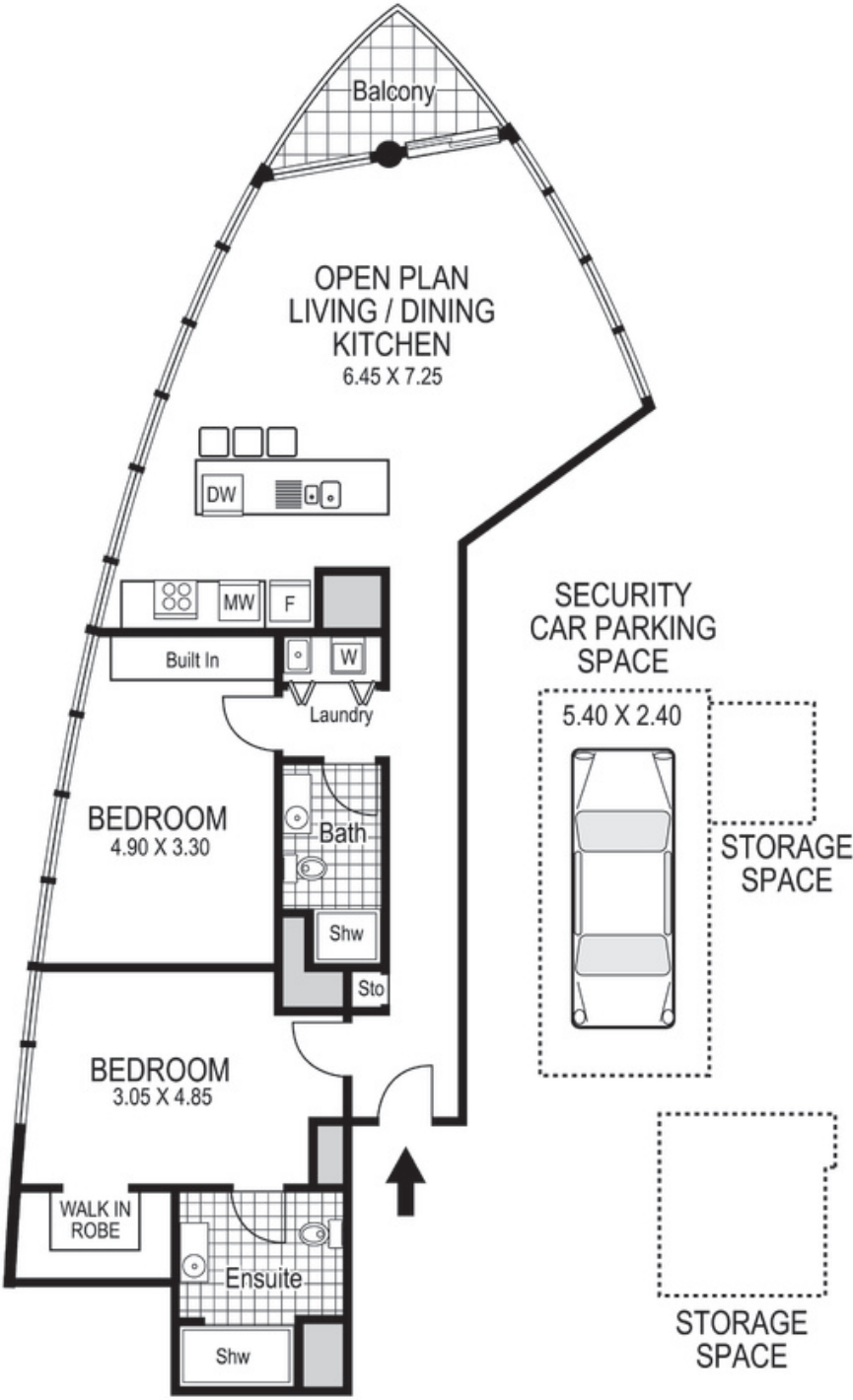

1109 / 20 Pelican Street DARLINGHURST  
*"MONUMENT"*

Plans shown are for presentation purposes only and are not part of any legal document or title and are subject to errors, omissions inaccuracies and they should not be used as the sole and/or accurate reference for purchasing decision. Interested parties should make their own inquiries using other sources supplied. Dimensions in length and width are approximate. Illustration by Raoul Isidro 0411128500

Every precaution has been taken to establish accuracy of the information in this brochure but does not constitute any representation by the vendor or agent.