



## 3/5 Springfield Avenue POTTS POINT, NSW

2 bed | 1 bath

**R&W**

Positioned in the gorgeous Marden Hall, this unrenovated 2-bedroom Strata apartment stands as an exciting chance to craft a lovely bespoke home. Harking back to the area's famed Bohemian days and in definite need of some TLC, with an imaginative touch and astute design, this apartment stands ready to be transformed into a fine residence in the heart of a prized precinct. First time offered in 40 years!

- Flowing layout, great scope for imaginative reconfiguration
- 2 large bedrooms, west-facing master, massive kitchen space

[rwebay.com.au/4449748](https://rwebay.com.au/4449748)

Angelo Bouras 0401 658 653

Andrew Hoggett 0412 208 614

**Proudly Richardson&Wrench**

Richardson & Wrench Elizabeth Bay / Potts Point  
02 8356 2700



Elizabeth Bay  
TEL: 02 8356 2700

3/5 Springfield Avenue  
POTTS POINT

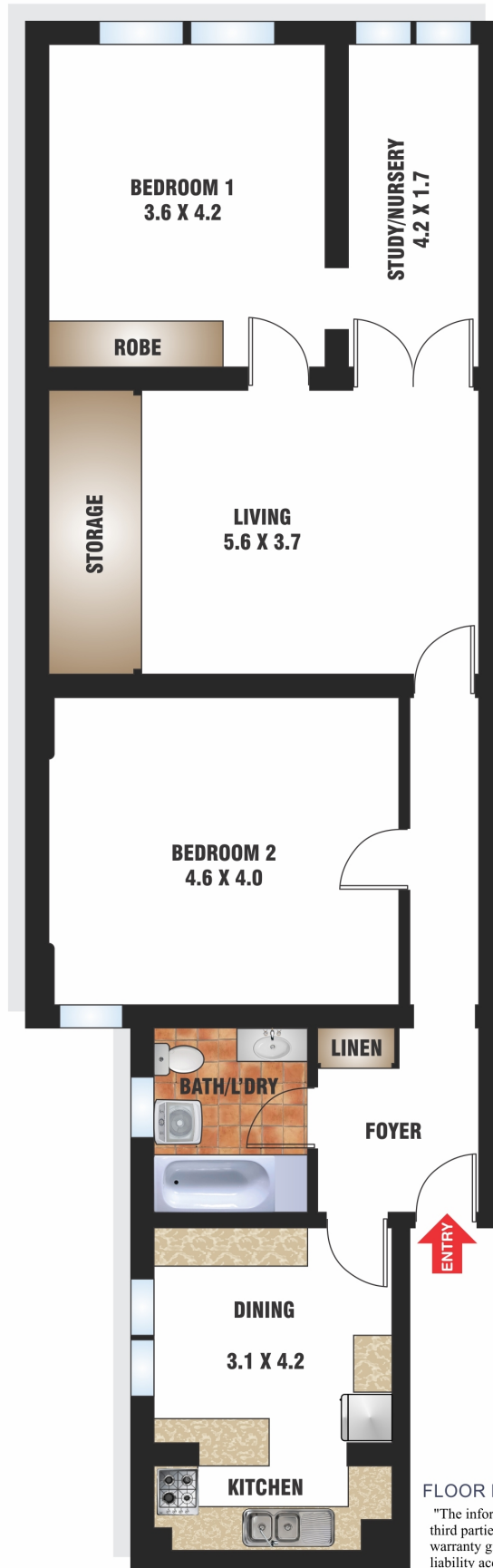

FLOOR PLAN BY BORTEX PTY LTD PH: 0414 922 679

"The information contained herein has been provided by our Principal and third parties, which we merely pass on without any representation or warranty given, intended or implied by us as to its correctness and with no liability accepted by us in this regard. You must rely on your own inquiries as to its accuracy or otherwise."

Every precaution has been taken to establish accuracy of the information in this brochure but does not constitute any representation by the vendor or agent.

