



32/4 Macleay Street POTTS POINT, NSW

2 bed | 1 bath

This apartment's spacious layout is set well above the sought-after Paris end of Macleay Street with a scenic village-green aspect from all living areas. Quiet and private on the 3rd floor of the tightly held FOUR Macleay Street, a landmark classic c.1938 security block with grand Art Deco influences.

- * Leafy aspect from all windows and water glimpses
- * Direct lift access from grand entry hall
- * Traditional entrance hall with built-in cupboards & bookshelves
- * Separate kitchen with gas and heaps of storage/bench ...

R&W

rwebay.com.au/4997667

Greg McKinley 0412 044 822

Penny Timothy 0418 546 500

Proudly Richardson&Wrench

Richardson & Wrench Elizabeth Bay / Potts Point
02 8356 2700

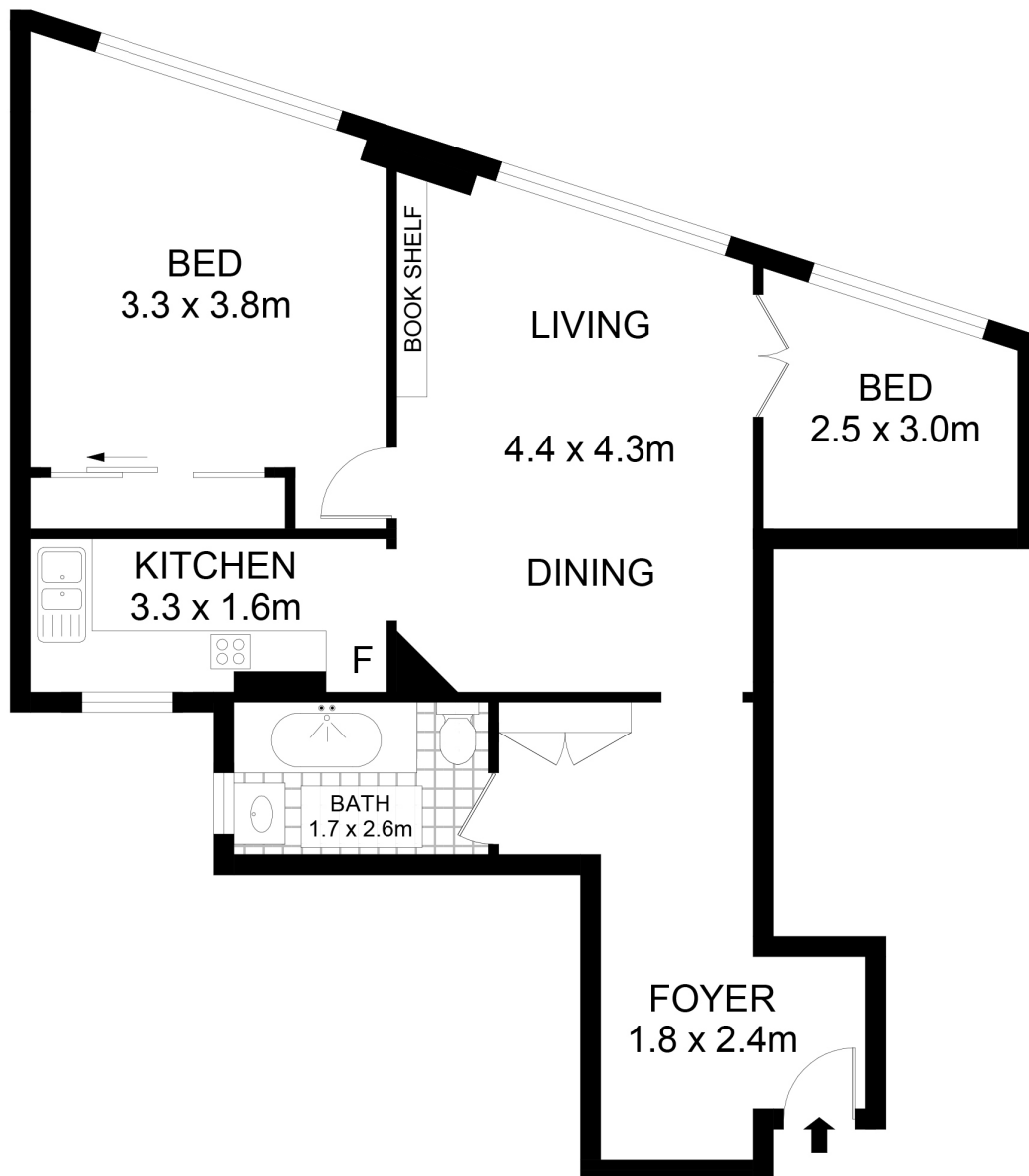

32/4 Macleay Street, Potts Point



Disclaimer

Floor Plan measurements are approximate and are for illustrative purposes only. While we cannot doubt the floor plans accuracy, we make no guarantee, warranty or representation as to the accuracy and completeness of the floor plan.

Every precaution has been taken to establish accuracy of the information in this brochure but does not constitute any representation by the vendor or agent.

R&W