



15/4 Waratah Street RUSHCUTTERS BAY, NSW

1 bed | 1 bath

Fastidiously rebuilt from a classic Art Deco shell, this stylish contemporary apartment offers a well priced entry point to a sought after cosmopolitan locale. Alongside beautiful harbourfront Rushcutters Bay Park, this idyllic investment in lifestyle enjoys parkland views and a quiet 1st floor position in Woodlands, a gracious circa 1930 tightly-held secure block of 25.

* Classic paneled lobby, well maintained building with dual street access

R&W

rwebay.com.au/502499

Luke McDonnell 0418 844 110

Angelo Bouras 0401 658 653

Proudly Richardson&Wrench

Richardson & Wrench Elizabeth Bay / Potts Point
02 8356 2700

Contact:
Luke McDonnell
0418 844 110

R&W | The best reputation
in real estate
Elizabeth Bay / Potts Point

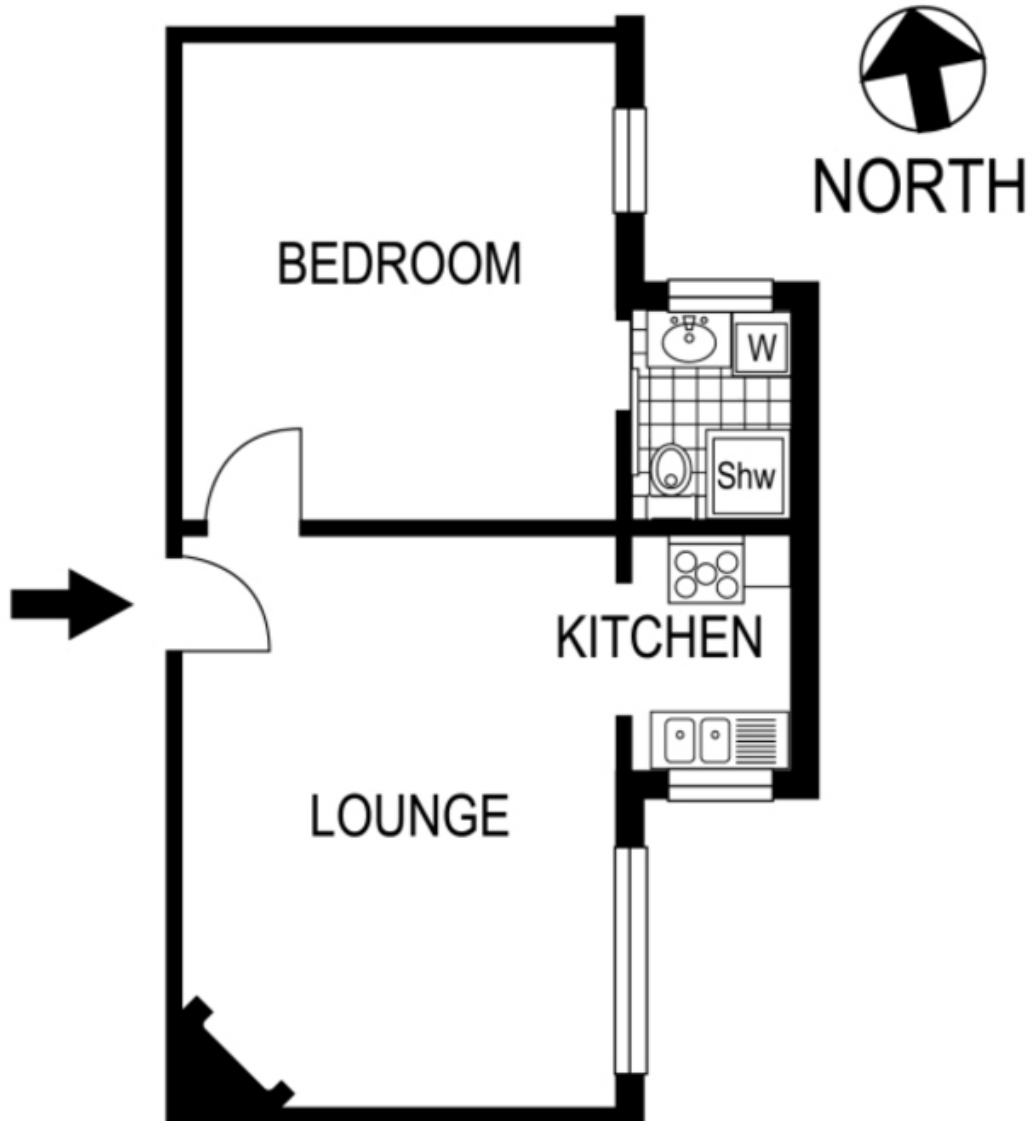

15 / 4 Waratah Street
RUSHCUTTERS BAY

"WOODLANDS"

© Dimensions shown on plans are approximate values in L x W
Colour formulas and area coding are subject to copyright
Illustration by Raoul Isidoro 04111 28500

Plans shown are for presentation purposes only and are not part of any legal document or title and are subject to errors, omissions, inaccuracies and they should not be used as sole and/or accurate reference for purchasing decision. Interested parties should make their own enquiries using other sources supplied.

Every precaution has been taken to establish accuracy of the information in this brochure but does not constitute any representation by the vendor or agent.

R&W