



44/4 Ward Avenue ELIZABETH BAY, NSW

1 bed | 1 bath

Offering approximately 48sqm of open plan living this sunny apartment is securely located on the 4th floor of the stunning 'Marlborough Hall' circa 1938. An incredible lifestyle awaits with an outdoor pool, gardens & easy access to transport and the CBD.

- [x] Stunning building circa 1938 designed by Emil Sodersten
- [x] Sunny living space with separate dining
- [x] High ceilings & period features
- [x] Newly renovated kitchen with dishwasher & gas cooking

R&W

rwebay.com.au/5345719

Luke McDonnell 0418 844 110

Greg McKinley 0412 044 822

Proudly Richardson&Wrench

Richardson & Wrench Elizabeth Bay / Potts Point
02 8356 2700

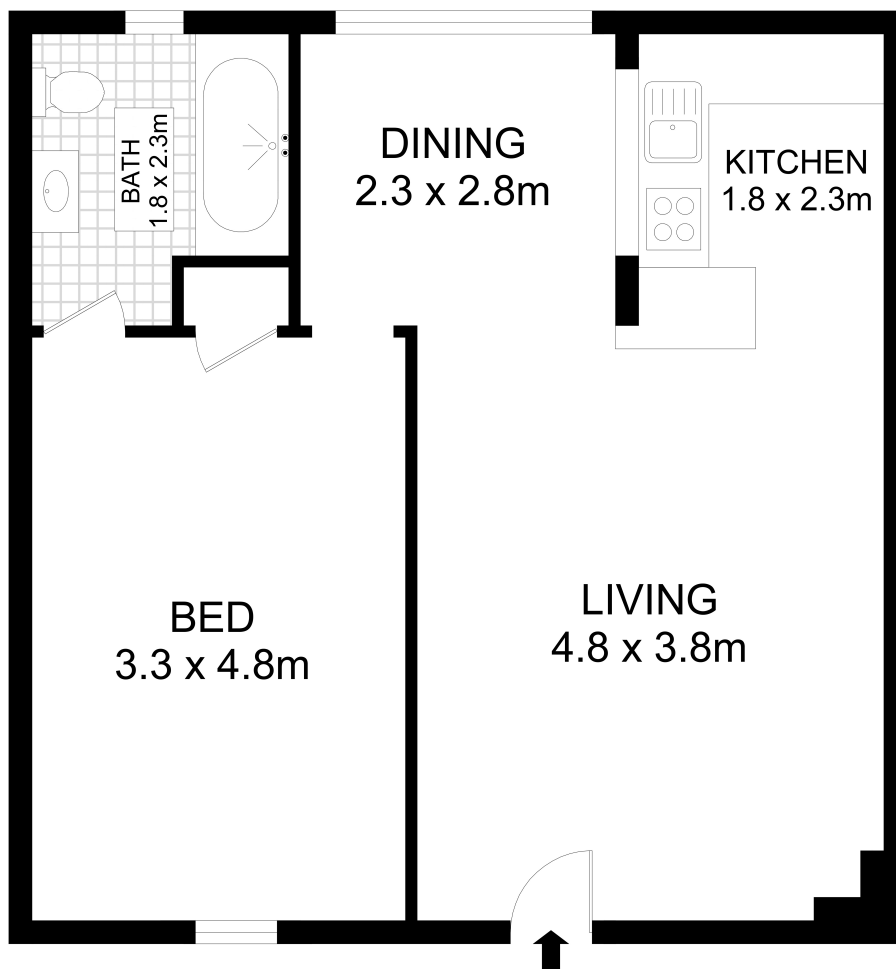

44/4 Ward Avenue, Elizabeth Bay

Disclaimer

Floor Plan measurements are approximate and are for illustrative purposes only. While we cannot doubt the floor plans accuracy, we make no guarantee, warranty or representation as to the accuracy and completeness of the floor plan.