



12/40-44 Victoria Street Potts Point, NSW

| 1 bath

Positioned on the prized North West corner on Level 3 of the Harry Seidler 'Gemini' building, the apartment boasts one of the best postcard views in Potts Point.

The apartment is move-in ready or a renovation opportunity to capitalise on the outstanding views.

The expansive windows provide excellent cross-flow and sunshine by day and a stunning aspect in the evening with views to the city skyline, Opera House and Harbour Bridge.

A concealed drop-down bed and built-in wardrobes are in...

R&W

rwebay.com.au/7284109

Penny Timothy 0418 546 500

Luke McDonnell 0418 844 110

Proudly Richardson&Wrench

Richardson & Wrench Elizabeth Bay / Potts Point
02 8356 2700

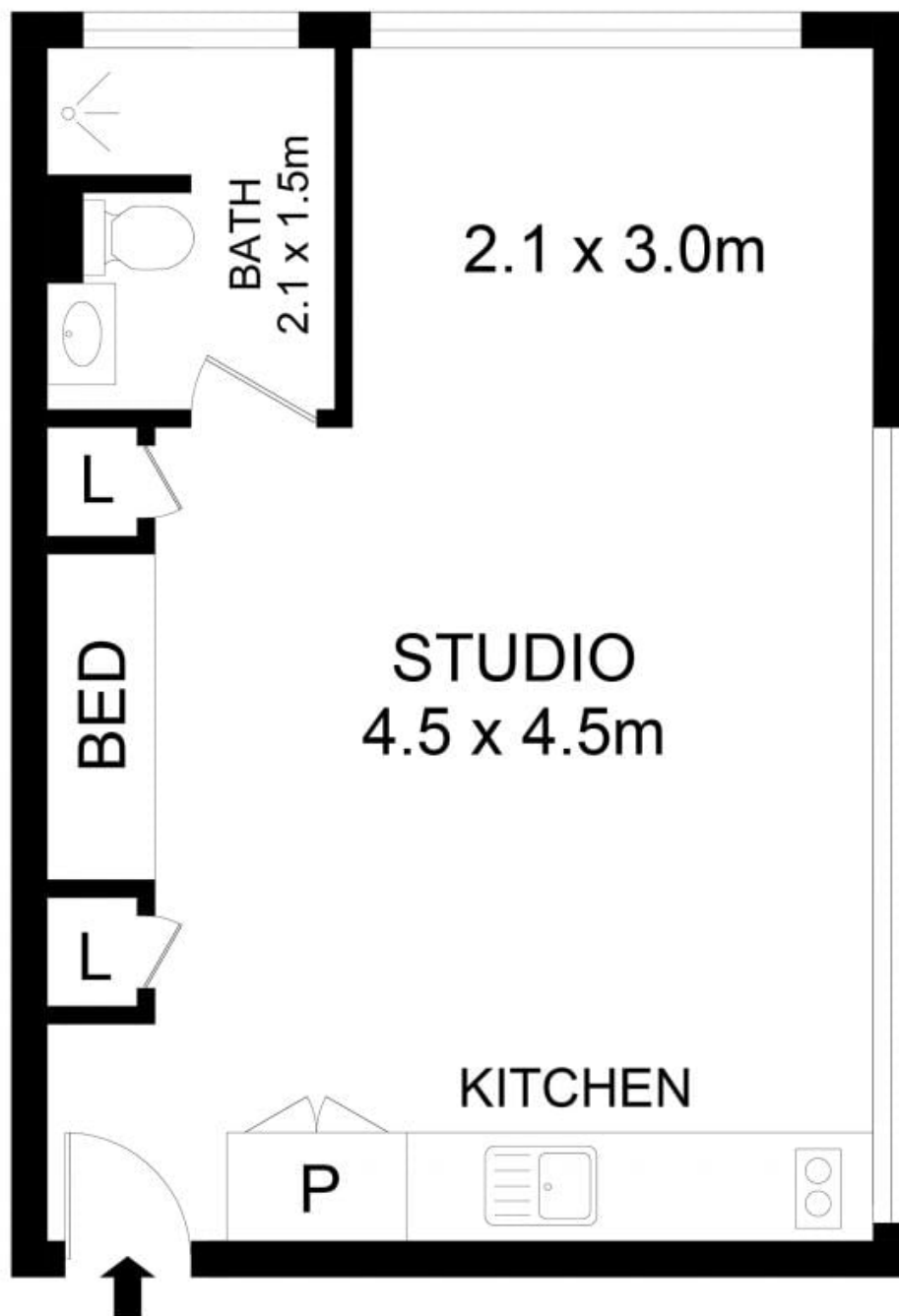
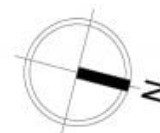

12/40-44 Victoria Street, Potts Point

Disclaimer

Floor Plan measurements are approximate and are for illustrative purposes only. While we cannot doubt the floor plans accuracy, we make no guarantee, warranty or representation as to the accuracy and completeness of the floor plan.

Every precaution has been taken to establish accuracy of the information in this brochure but does not constitute any representation by the vendor or agent.

