



6/342 Edgecliff Road Woollahra, NSW

2 bed | 1 bath | 1 car

Beautifully positioned in a small boutique block of just 12, this sun drenched Art Deco apartment enjoys leafy district views while conveniently located in the heart of Woollahra. Offering a spacious 84sqm floorplan, great natural light, character art-deco features, sunny balcony, eat-in kitchen, internal laundry facilities and huge 24sqm remote control lock up garage. Well positioned just a short walk to Queen Street village shops, cafes, local schools, Westfield Bondi Junction, train & bus interchange.

Council Rates: \$366pq...

R&W

rwebay.com.au/7311090

Rod Angus 0419 599 888

Proudly Richardson&Wrench

Richardson & Wrench Elizabeth Bay / Potts Point
02 8356 2700



Elizabeth Bay
TEL: 02 8356 2700

6/342 Edgecliff Road
WOOLLAHRA

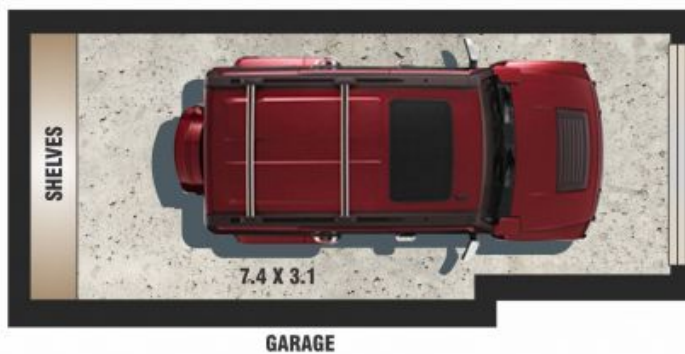
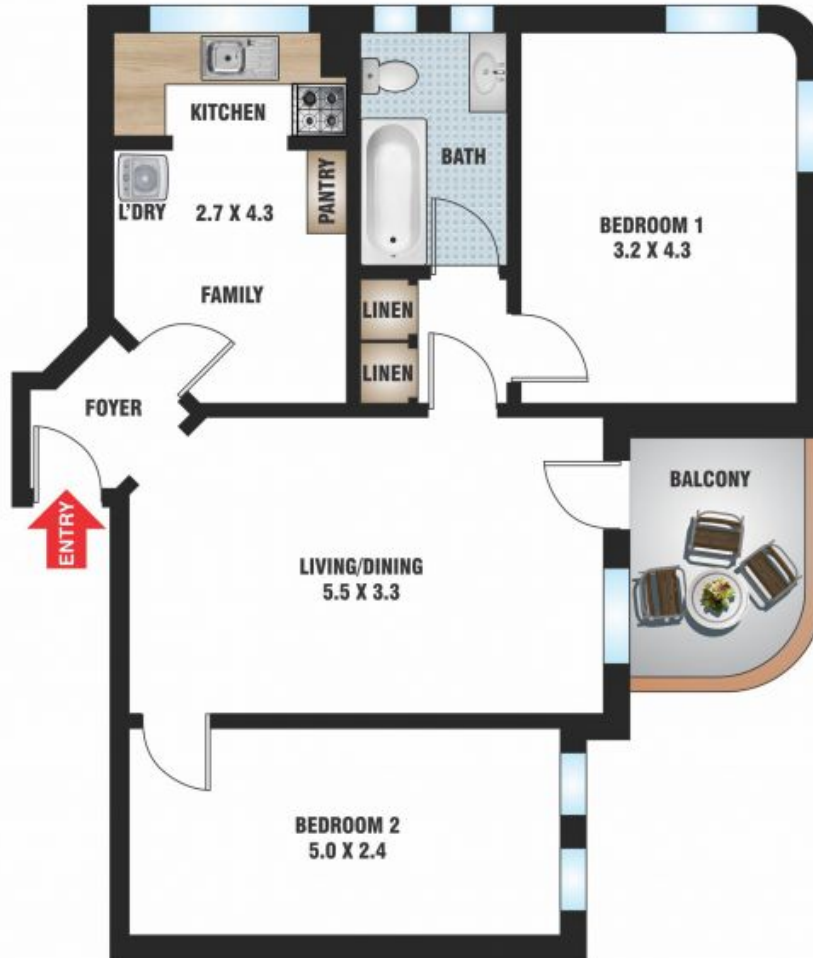

FLOOR PLAN BY BORTEX PTY LTD PH: 0414 922 679

"The information contained herein has been provided by our Principal and third parties, which we merely pass on without any representation or warranty given, intended or implied by us as to its correctness and with no liability accepted by us in this regard. You must rely on your own inquiries as to its accuracy or otherwise."

Every precaution has been taken to establish accuracy of the information in this brochure but does not constitute any representation by the vendor or agent.

