



## 27/60-70 William Street Woolloomooloo, NSW

1 bed | 1 bath

**R&W**

Combining cutting edge design elements and a sophisticated city-fringe address, this luxuriously large apartment claims a coveted North aspect with park and harbour views, in the landmark 'Paramount' building. In a cosmopolitan address on the border of Woolloomooloo and Darlinghurst, you're only footsteps from Hyde Park and minutes stroll to Potts Point, Town Hall and the heart of the CBD. Designed to optimise on space and natural light, the apartment offers a resort inspired atmosphere with high class amenities and a rooftop terrace.

[rwebay.com.au/7562954](https://rwebay.com.au/7562954)

Angelo Bouras 0401 658 653

**Proudly Richardson&Wrench**

Richardson & Wrench Elizabeth Bay / Potts Point  
02 8356 2700

Approximate Outgoings:...

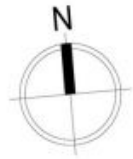
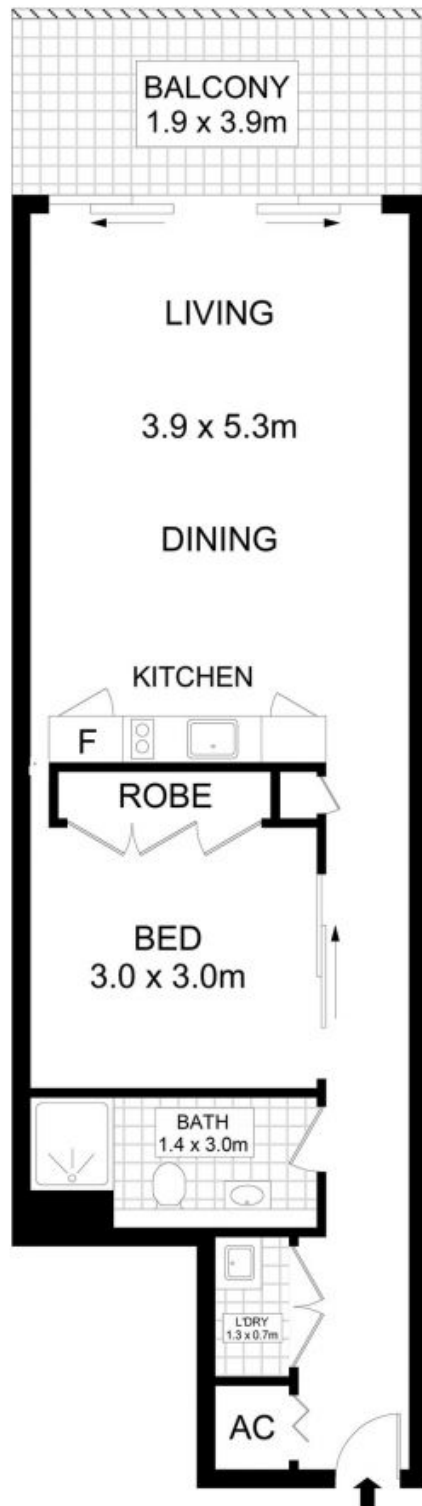

## 27/60-70 William Street, Woolloomooloo

### Disclaimer

Floor Plan measurements are approximate and are for illustrative purposes only. While we cannot doubt the floor plans accuracy, we make no guarantee, warranty or representation as to the accuracy and completeness of the floor plan.