



6/7 Kellett Street Potts Point, NSW

1 bed | 1 bath

Sunny apartment on the top floor of a beautifully presented terrace. Offering approx. 38sqm of indoor/outdoor living. The apartment offers a wonderful home or investment opportunity, footsteps to cafes, restaurants, nightlife, transport, it is a truly exciting lifestyle.

Top floor apartment with fabulous natural light
Open plan living with timber style floors
Plantation shutters throughout
Updated modern kitchen

Outgoings (approx.)...

R&W

rwebay.com.au/7597221

Greg McKinley 0412 044 822

Penny Timothy 0418 546 500

Proudly Richardson&Wrench

Richardson & Wrench Elizabeth Bay / Potts Point
02 8356 2700

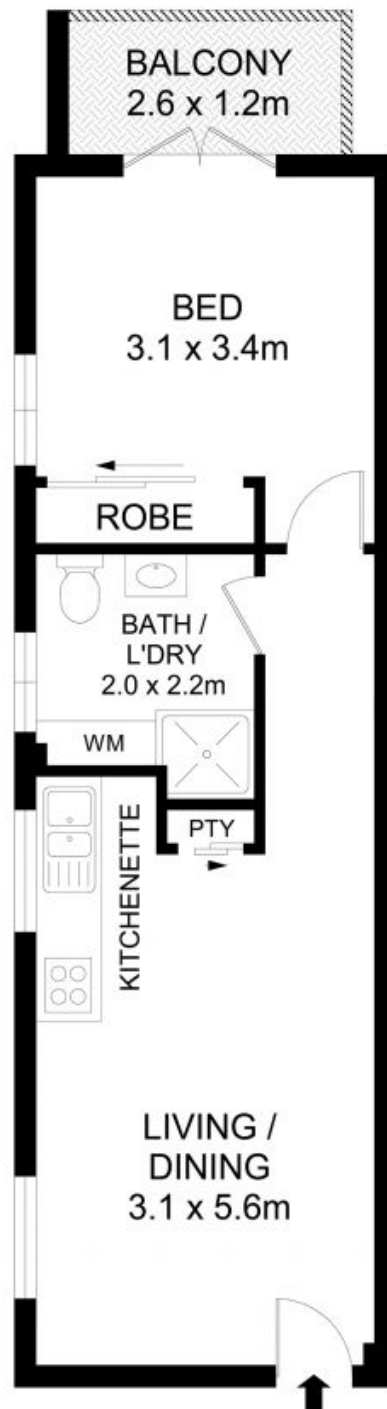
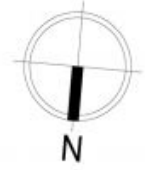

6/7 Kellett Street, Potts Point



Disclaimer

Floor Plan measurements are approximate and are for illustrative purposes only. While we cannot doubt the floor plans accuracy, we make no guarantee, warranty or representation as to the accuracy and completeness of the floor plan.

Every precaution has been taken to establish accuracy of the information in this brochure but does not constitute any representation by the vendor or agent.

R&W