



## 16/29 Elizabeth Bay Road Elizabeth Bay, NSW

1 bed | 1 bath

Sophisticated top floor one bedroom with Rushcutters Bay Views

Set in the heart of Elizabeth Bay, in one of the area's charming and fashionable Art Deco building the 'Emerson'.

Featuring well-proportioned living/dining space with solid timber floors, a modern, well equipped crisp-white kitchen and bathroom with tub, high ceilings and period features throughout.

Approximate outgoings per quarter:...

# R&W

[rwebay.com.au/7598947](http://rwebay.com.au/7598947)

Luke McDonnell 0418 844 110

Penny Timothy 0418 546 500

**Proudly Richardson&Wrench**

Richardson & Wrench Elizabeth Bay / Potts Point  
02 8356 2700

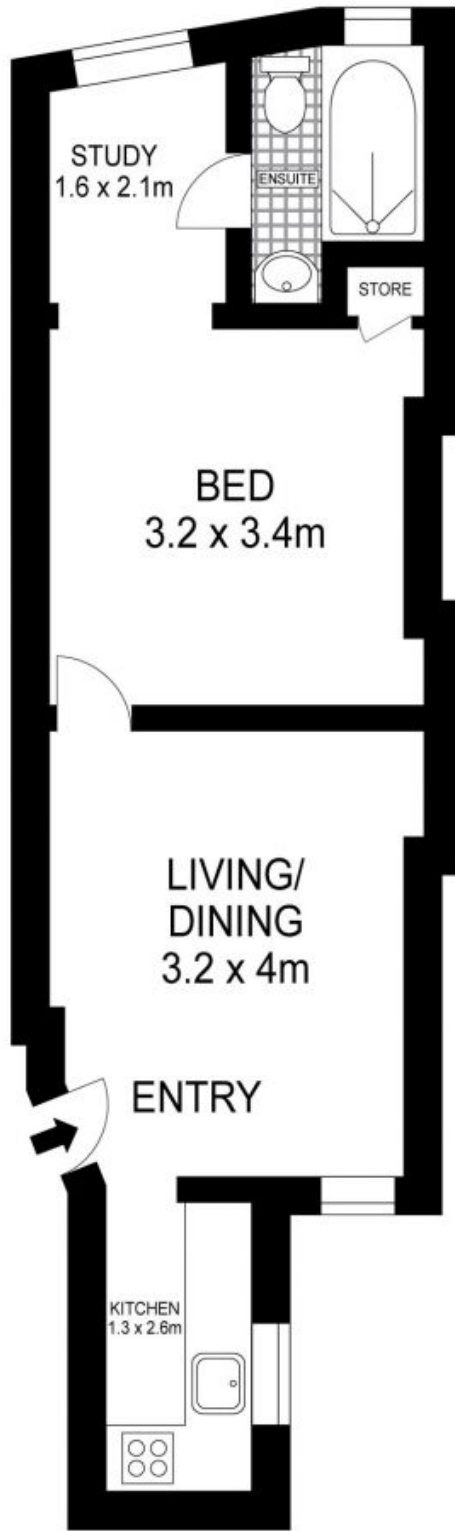

**LEVEL THREE**



Scale in metres. Indicative only. Dimensions are approximate. All information contained herein is gathered from sources we believe to be reliable. However, we cannot guarantee its accuracy and interested persons should rely on their own enquiries.

16/29 Elizabeth Bay Road, Elizabeth Bay



Every precaution has been taken to establish accuracy of the information in this brochure but does not constitute any representation by the vendor or agent.