



5/18 Onslow Avenue Elizabeth Bay, NSW

1 bed | 1 bath

A North-East aspect in this beautifully presented apartment is positioned on the garden level of the distinctive Art Deco Eltham building. The property has a bright breezy aspect of leafy surrounds. This delightful apartment features open plan living and dining, timber floors and large sash windows throughout.

- The main bedroom includes a full height wardrobe,
- Bay window, private and pleasant outlook and excellent crossflow ventilation.

The building has been recently upgraded with a new entr...

R&W

rwebay.com.au/7701158

Angelo Bouras 0401 658 653

Proudly Richardson&Wrench

Richardson & Wrench Elizabeth Bay / Potts Point
02 8356 2700

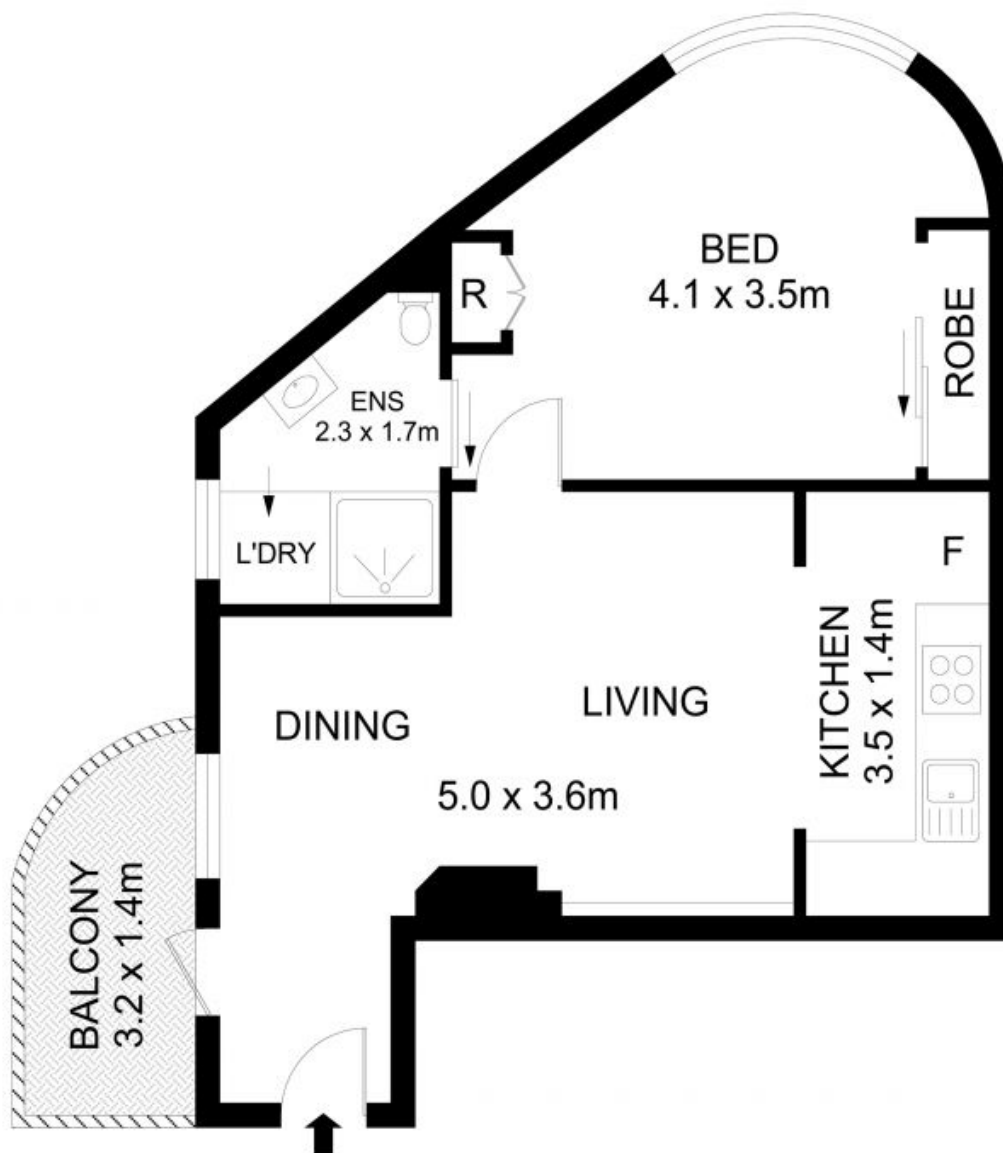

5/18 Onslow Avenue, Elizabeth Bay

Disclaimer

Floor Plan measurements are approximate and are for illustrative purposes only. While we cannot doubt the floor plans accuracy, we make no guarantee, warranty or representation as to the accuracy and completeness of the floor plan.

Every precaution has been taken to establish accuracy of the information in this brochure but does not constitute any representation by the vendor or agent.

R&W