



15/97-99 Macleay Street Potts Point, NSW

2 bed | 1 bath

R&W

- Set in iconic 1928 Art Deco "Byron Hall"
- Exemplifies the finest of Potts Point living
- Radiant corner position, N-facing outlook
- Balcony with CBD, Harbour Bridge views
- Balcony access from kitchen, living, master
- Spacious living/dining flows from entry foyer
- 2 sunlit bedrooms, 2nd w/ multi-use scope
- Chic galley kitchen, bathroom w/ full bath

rwebay.com.au/7716791

Jason Boon 0418 671 494

Joss Reid 0414 662 391

Geoff Cox 0418 231 004

Proudly Richardson&Wrench

Richardson & Wrench Elizabeth Bay / Potts Point
02 8356 2700

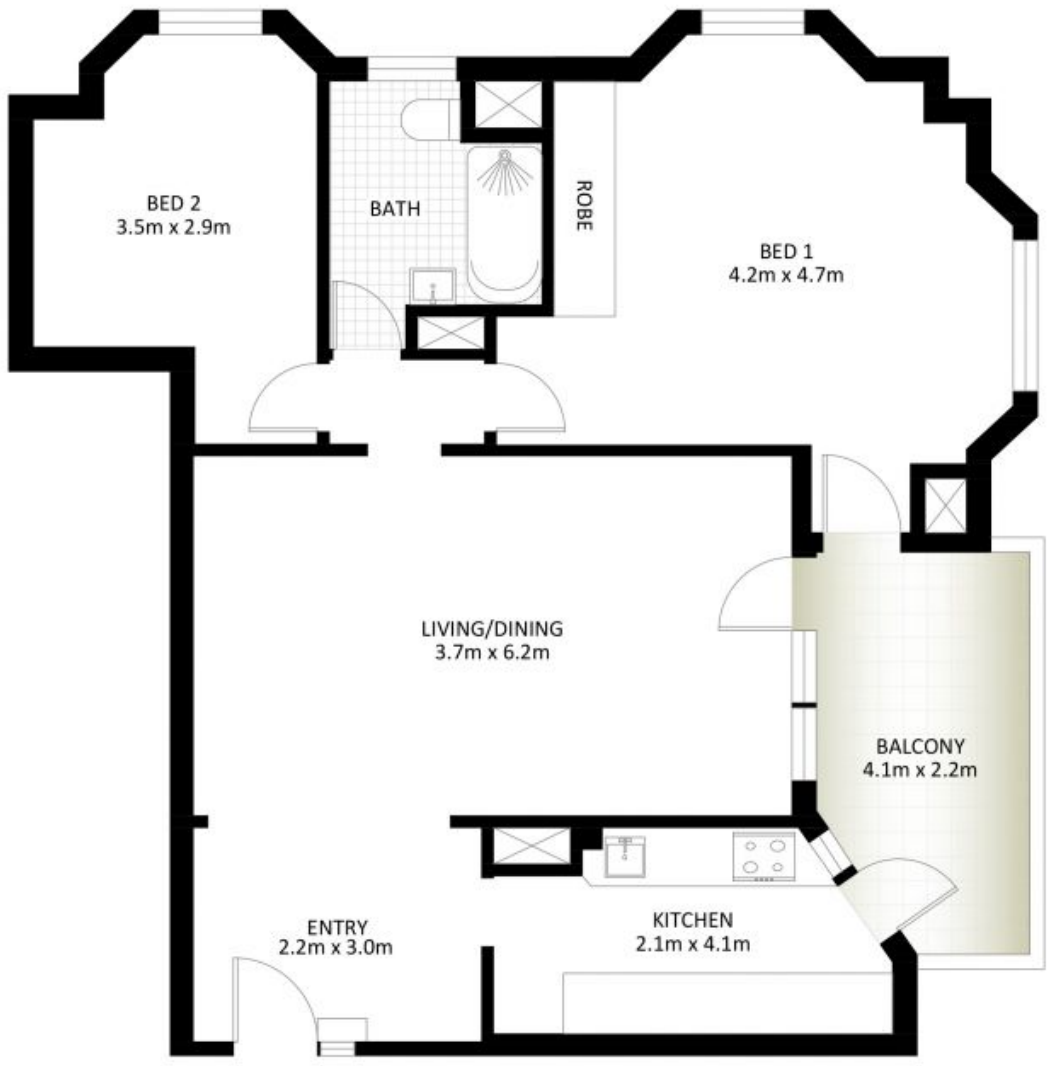

15/97-99 Macleay Street, Potts Point

*PLANS SHOWN ONLY INDICATIVE OF LAYOUT. DIMENSIONS ARE APPROXIMATE.

Measurements are approximate and not to scale. The vendor, agency and supplier will accept no liability for its accuracy. Interested parties are advised to make their own independent enquiries.