



## 33A/100 Elizabeth Bay Road Elizabeth Bay, NSW

| 1 bath

**R&W**

Situated in International Lodge, this apartment offers a quiet position in a recently refurbished building in the desirable Elizabeth Bay loop.

Feature Include:

- Large windows with loads of natural light
- Pleasant outlook with water views
- Renovated kitchen with marble benchtops
- Rooftop with wraparound views and common facilities
- Direct lift access with updated common areas

Approx Outgoings:...

[rwebay.com.au/7819357](http://rwebay.com.au/7819357)

Angelo Bouras 0401 658 653

**Proudly Richardson&Wrench**

Richardson & Wrench Elizabeth Bay / Potts Point  
02 8356 2700

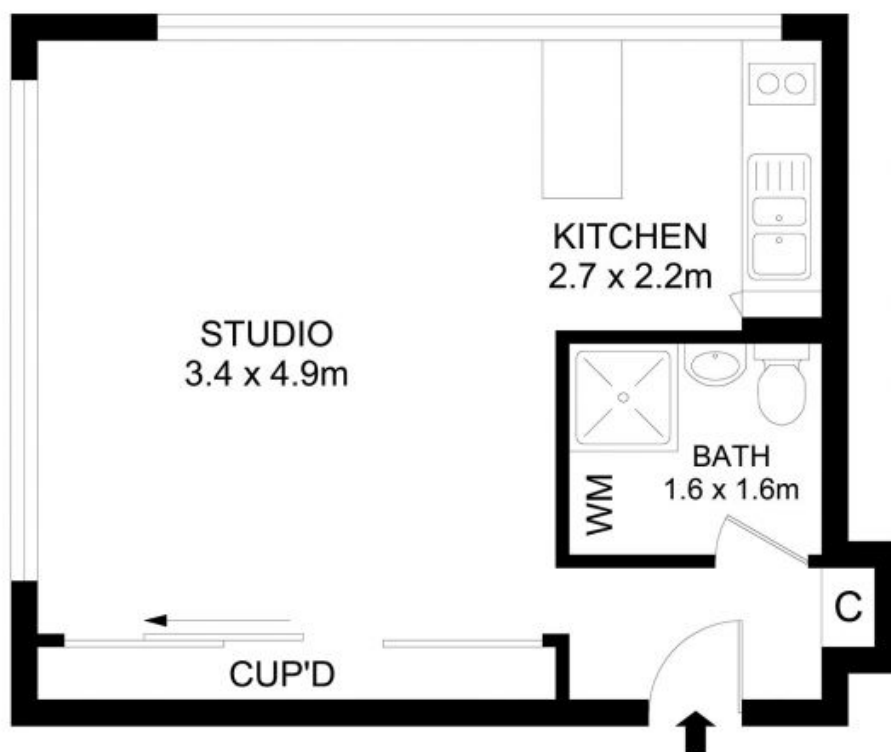

## 33A/100 Elizabeth Bay Road, Elizabeth Bay

### Disclaimer

Floor Plan measurements are approximate and are for illustrative purposes only. While we cannot doubt the floor plans accuracy, we make no guarantee, warranty or representation as to the accuracy and completeness of the floor plan.