



11a Chapman Avenue Maroubra, NSW

4 bed | 2 bath | 1 car

- Delightful 4-bedroom home in prime beachside locale
- Remarkably quiet setting adjoining John Shore Park
- Superb living area flows to rear outdoor zone with pool
- Excellent entertainer's courtyard, 2nd access to park
- Upper master suite with b/ins, gorgeous private balcony
- 2 further upper bedrooms, radiant lower bed, with b/ins
- Convenient off-street parking, handy outdoor shower
- High ceilings, beautiful floorboards, internal laundry
- Steps to beach, schools, cafes, easy trip to shopping

R&W

rwebay.com.au/7833499

Andrew Hoggett 0412 208 614

Luke McDonnell 0418 844 110

Proudly Richardson&Wrench

Richardson & Wrench Elizabeth Bay / Potts Point
02 8356 2700



11a Chapman Avenue
 MAROUBRA

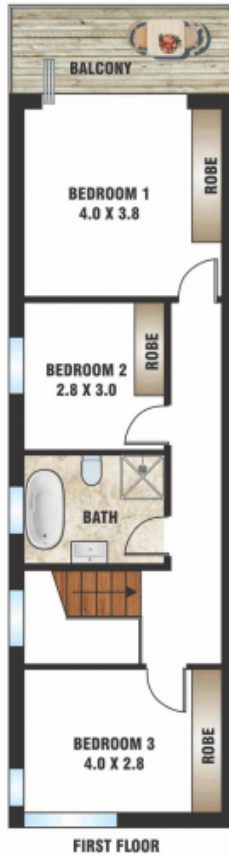

FLOOR PLAN BY BORTEX PTY LTD PH: 0414 922 679

"The information contained herein has been provided by our Principal and third parties, which we merely pass on without any representation or warranty given, intended or implied by us as to its correctness and with no liability accepted by us in this regard. You must rely on your own inquiries as to its accuracy or otherwise."

Every precaution has been taken to establish accuracy of the information in this brochure but does not constitute any representation by the vendor or agent.