



## 20/3 Clement Street Rushcutters Bay, NSW

2 bed | 1 bath | 1 car

**R&W**

Located in a quiet leafy cul-de-sac in close proximity to Rushcutters Bay Park and the harbour, this light-filled apartment offers a spacious layout with open plan living and dining areas that flow seamlessly to the idyllic private balcony. Situated in a tightly held security block, this comfortable and airy apartment is perfectly located in an unspoiled and highly sought after harbourside enclave. A short distance from the tennis courts, local parks, marinas, public transport and Darlinghurst and Potts Point dining amenities.

[rwebay.com.au/7880779](https://rwebay.com.au/7880779)

Angelo Bouras 0401 658 653

**Proudly Richardson&Wrench**

Richardson & Wrench Elizabeth Bay / Potts Point  
02 8356 2700

Approx Outgoings:...

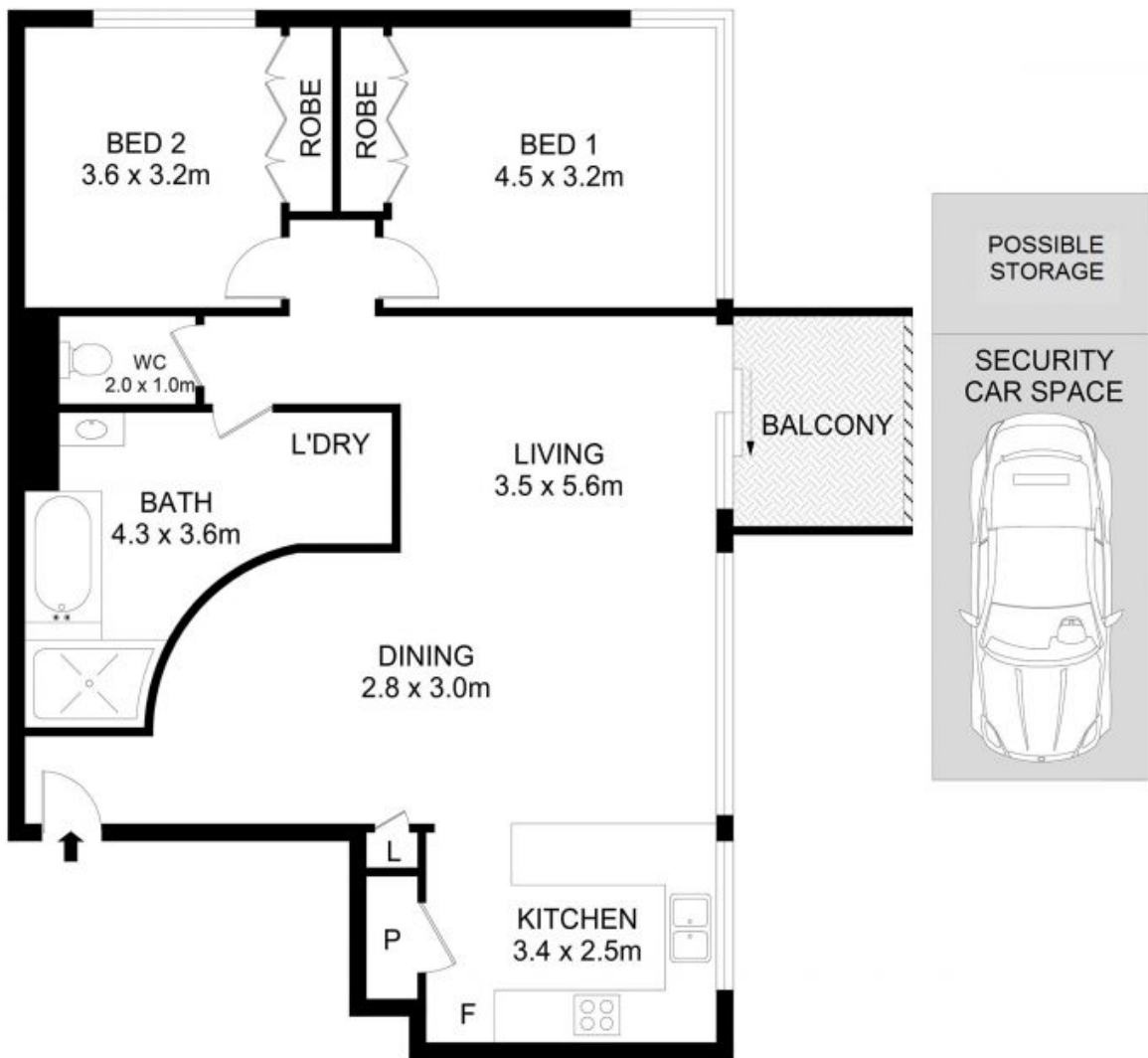
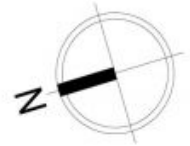

## 20/3 Clement Street, Rushcutters Bay



### Disclaimer

Floor Plan measurements are approximate and are for illustrative purposes only. While we cannot doubt the floor plans accuracy, we make no guarantee, warranty or representation as to the accuracy and completeness of the floor plan.

Every precaution has been taken to establish accuracy of the information in this brochure but does not constitute any representation by the vendor or agent.

**R&W**