

## 31/8 Greenknowe Avenue Elizabeth Bay, NSW

2 bed | 2 bath | 1 car

**R&W**

Beautifully situated in a resort-like complex, this 2-level abode is a fabulous residence flooded with sunlight. The living/dining area is a radiant zone flowing to a terrace with glimpses to the harbour. In a sought-after building featuring concierge, gym, and pool, this sleek home is perfectly positioned to enjoy all the lifestyle highlights of the neighbourhood. Internal laundry and the convenience of secure underground parking, it ticks all the boxes for perfect city-side living.

\* Sunny 2-bedroom home in resort-like complex

Approx Outgoings:...

**[rwebay.com.au/7918343](https://rwebay.com.au/7918343)**

Angelo Bouras 0401 658 653

**Proudly Richardson&Wrench**

Richardson & Wrench Elizabeth Bay / Potts Point  
02 8356 2700

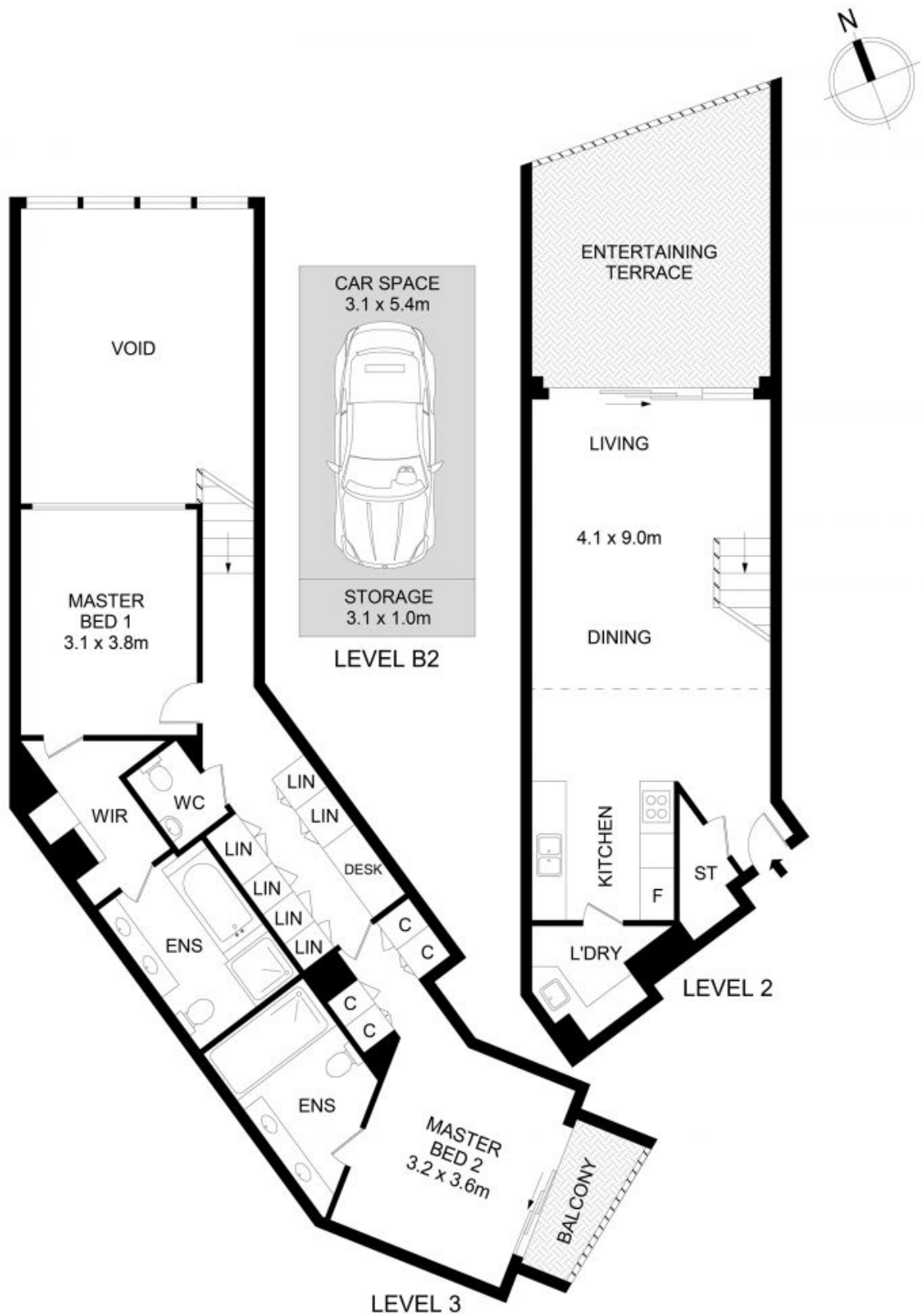

## 31/8 Greenknowe Avenue, Elizabeth Bay



### Disclaimer

Floor Plan measurements are approximate and are for illustrative purposes only. While we cannot doubt the floor plans accuracy, we make no guarantee, warranty or representation as to the accuracy and completeness of the floor plan.

Every precaution has been taken to establish accuracy of the information in this brochure but does not constitute any representation by the vendor or agent.

**R&W**