



14/3 Clement Street Rushcutters Bay, NSW

2 bed | 1 bath | 1 car

Located in a quiet leafy cul-de-sac in close proximity to Rushcutters Bay Park and the harbour. A short distance from the tennis courts, local parks, marinas, public transport and Darlinghurst and Potts Point dining amenities.

*Designed by award winning Architects Ancher Mortlock & Woolley

*Strata building in a block of 25

*Located in a security block with two internal lifts

*Secure parking with storage cage and visitor parking

R&W

rwebay.com.au/7934900

Angelo Bouras 0401 658 653

Proudly Richardson&Wrench

Richardson & Wrench Elizabeth Bay / Potts Point
02 8356 2700

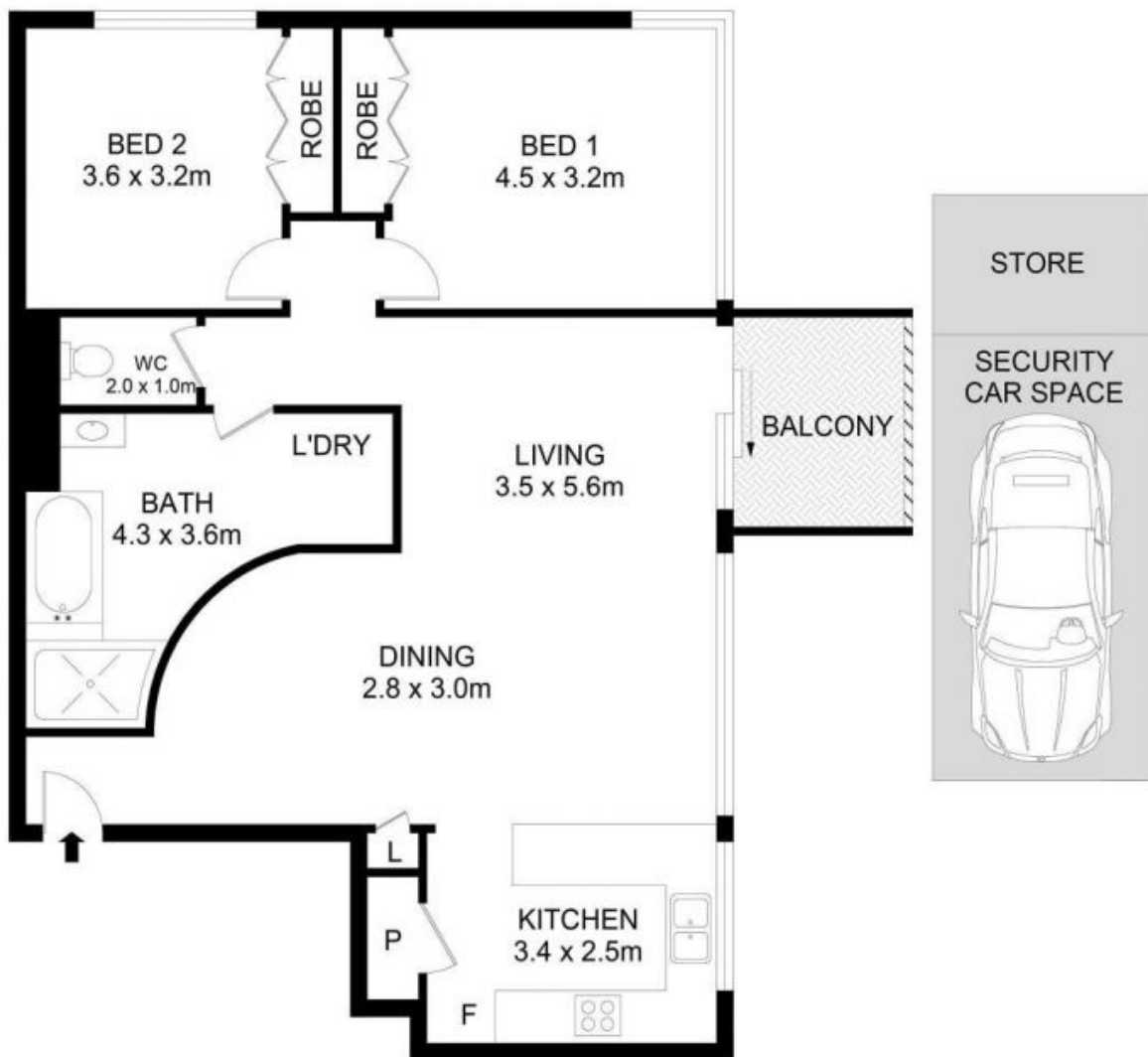
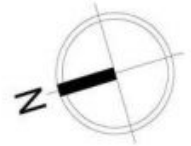

14/3 Clement Street, Rushcutters Bay



Disclaimer

Floor Plan measurements are approximate and are for illustrative purposes only. While we cannot doubt the floor plans accuracy, we make no guarantee, warranty or representation as to the accuracy and completeness of the floor plan.

Every precaution has been taken to establish accuracy of the information in this brochure but does not constitute any representation by the vendor or agent.

R&W