



## 8/3 Clement Street Rushcutters Bay, NSW

2 bed | 1 bath | 1 car

**R&W**

Located in a quiet leafy cul-de-sac in close proximity to Rushcutters Bay Park and the harbour. A short distance from the tennis courts, local parks, marinas, public transport and Darlinghurst and Potts Point dining amenities.

\*Designed by award winning Architects Ancher Mortlock & Woolley

\*Strata building in a block of 25

\*Located in a security block with two internal lifts

\*Secure parking with storage cage and visitor parking

In conjunction with James Dunn 0404 387 777...

**[rwebay.com.au/7942193](https://www.rwebay.com.au/7942193)**

Angelo Bouras 0401 658 653

Thomas Arthurs 0414 026 412

**Proudly Richardson&Wrench**

Richardson & Wrench Elizabeth Bay / Potts Point  
02 8356 2700

8/3 CLEMENT STREET  
RUSHCUTTERS BAY

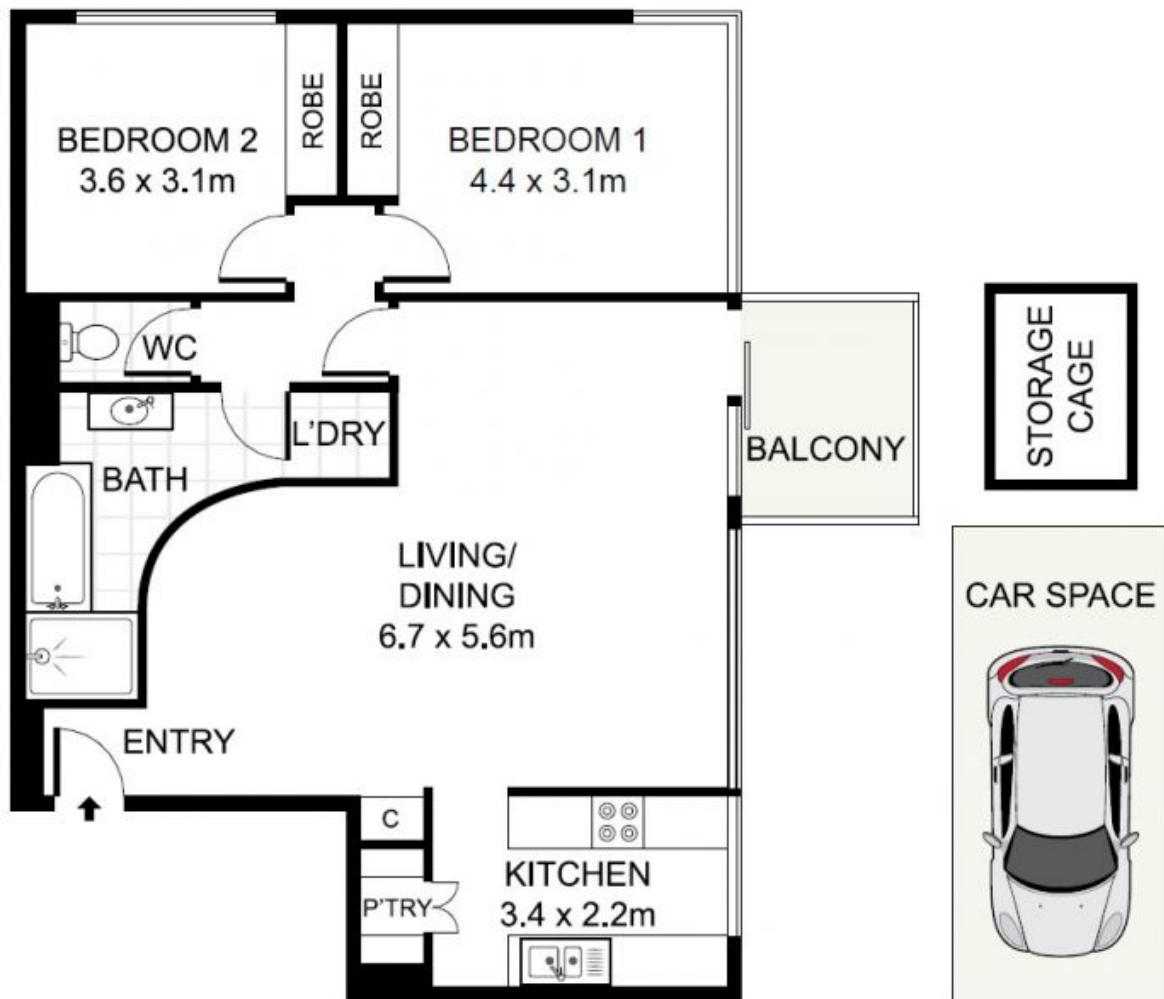

INT: 84 m<sup>2</sup>  
TOTAL: 98 m<sup>2</sup>

DISCLAIMER: PLANS SHOWN ARE FOR PRESENTATION PURPOSES AND ARE NOT PART OF ANY LEGAL DOCUMENT. ALL MEASUREMENTS AND FIGURES ARE APPROXIMATE.