



## 69/5-7 The Esplanade Elizabeth Bay, NSW

| 1 bath | 1 car

Perfectly presented 33sqm strata studio apartment, opposite Beare Park & the Harbour front of Elizabeth Bay. Complete with parking on title it offers the perfect city/harbourside base or quality investment.

- Open plan bright living
- Separate sleeping zone
- Updated kitchen & bathroom
- Original timber parquet floors
- Balcony with water & treetop aspect

Outgoings (approx.)...

# R&W

**Auction Thursday, 13th June 6:00 - On Site**

**[rwebay.com.au/7987259](http://rwebay.com.au/7987259)**

Greg McKinley 0412 044 822

Andrew Hoggett 0412 208 614

Luke McDonnell 0418 844 110

**Proudly Richardson & Wrench**

Richardson & Wrench Elizabeth Bay / Potts Point  
02 8356 2700

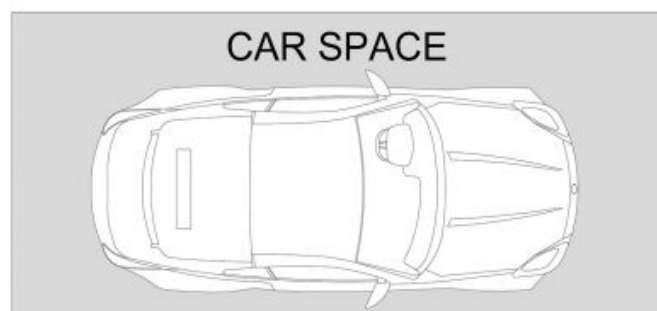
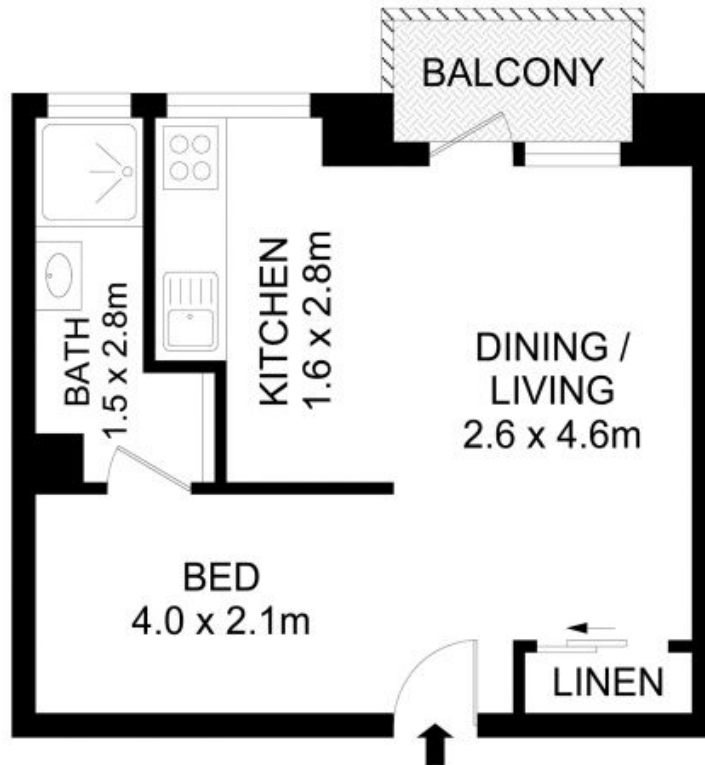
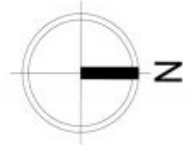

69/5 Esplanade, Elizabeth Bay

**Disclaimer**

Floor Plan measurements are approximate and are for illustrative purposes only. While we cannot doubt the floor plans accuracy, we make no guarantee, warranty or representation as to the accuracy and completeness of the floor plan.

Every precaution has been taken to establish accuracy of the information in this brochure but does not constitute any representation by the vendor or agent.

