



## 61/141 Bayswater Road Rushcutters Bay, NSW

2 bed | 1 bath | 1 car

**R&W**

Nestled on the cusp of Rushcutters Bay Park, this inviting two-bedroom apartment is the epitome of Sydney Harbour-side living. Flooded with natural light, streaming through floor-to-ceiling glass, this apartment exudes a contemporary ambiance and seamless open plan living. Discover the perfect synergy of comfort, style, and convenience in this coveted harbourside abode, where every amenity is at your fingertips.

\*Recently refurbished kitchen, gas stovetop, integrated dw

...

[rwebay.com.au/8006924](http://rwebay.com.au/8006924)

Angelo Bouras 0401 658 653

Thomas Arthurs 0414 026 412

**Proudly Richardson&Wrench**

Richardson & Wrench Elizabeth Bay / Potts Point  
02 8356 2700

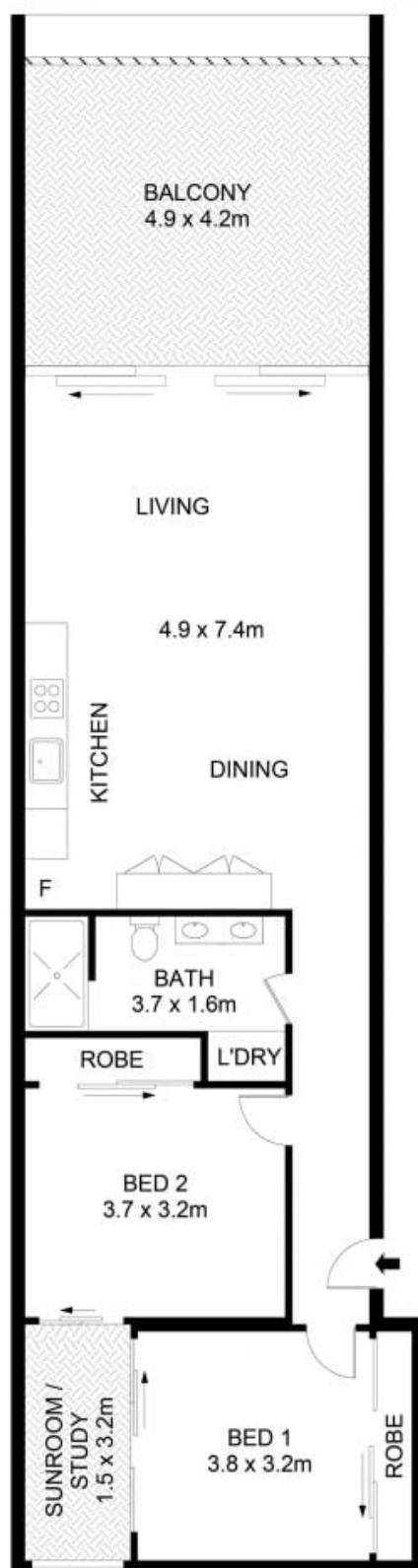
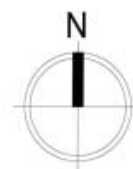

## 61/141 Bayswater Road, Rushcutters Bay



### Disclaimer

Floor Plan measurements are approximate and are for illustrative purposes only. While we cannot doubt the floor plans accuracy, we make no guarantee, warranty or representation as to the accuracy and completeness of the floor plan.

Every precaution has been taken to establish accuracy of the information in this brochure but does not constitute any representation by the vendor or agent.