



## 3/38 Roslyn Gardens Rushcutters Bay, NSW

1 bed | 1 bath

Discover timeless charm and modern convenience in this classic one bedroom apartment, nestled in the iconic 'Craigmore'-an Art Deco building dating back to the 1920s. Positioned on the doorstep of Rushcutters Bay Park, this residence offers a harmonious blend of historic elegance and contemporary living. A separate sunroom/study provides offering flexibility as a home office or storage. An ideal city pad with parks, transport and Potts Points village only moments away.

Approx Outgoings: ...

# R&W

[rwebay.com.au/8106328](https://rwebay.com.au/8106328)

Angelo Bouras 0401 658 653

Thomas Arthurs 0414 026 412

**Proudly Richardson&Wrench**

Richardson & Wrench Elizabeth Bay / Potts Point  
02 8356 2700

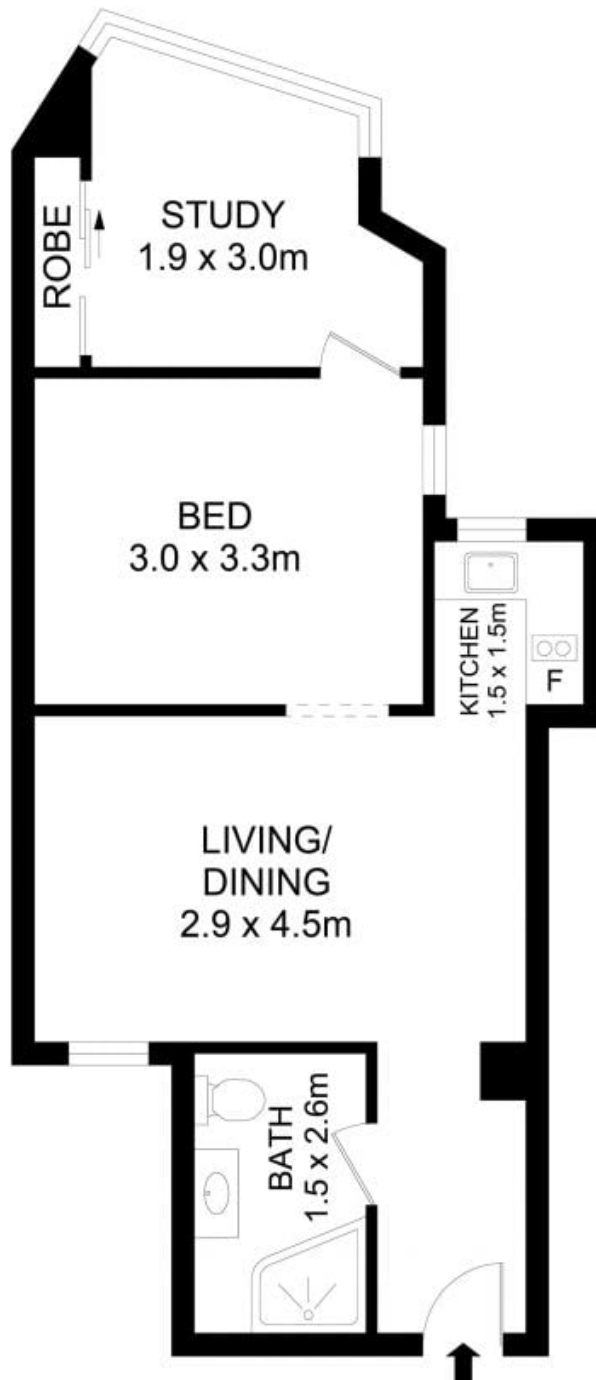

## 3/38 Roslyn Gardens, Rushcutters Bay

### Disclaimer

Floor Plan measurements are approximate and are for illustrative purposes only. While we cannot doubt the floor plans accuracy, we make no guarantee, warranty or representation as to the accuracy and completeness of the floor plan.

Every precaution has been taken to establish accuracy of the information in this brochure but does not constitute any representation by the vendor or agent.

**R&W**