



109/3-5 Greenknowe Avenue Elizabeth Bay, NSW

| 1 bath

R&W

"TARA" is an iconic heritage Art-Deco corner building, where its decorative brick exterior has two mirror image facades on Greenknowe Avenue & Baroda Street joining in a timeless beveled fashion with a single mass of windows leading up to a castellated geometric roofline. Featuring a Tudor arched entry, original period lobby and stained glass crested windows.

- Character features, high ceilings.
- Functional 33sqm floorplan / layout.

Strata: \$854pq...

rwebay.com.au/8152904

Rod Angus 0419 599 888

Proudly Richardson&Wrench

Richardson & Wrench Elizabeth Bay / Potts Point
02 8356 2700

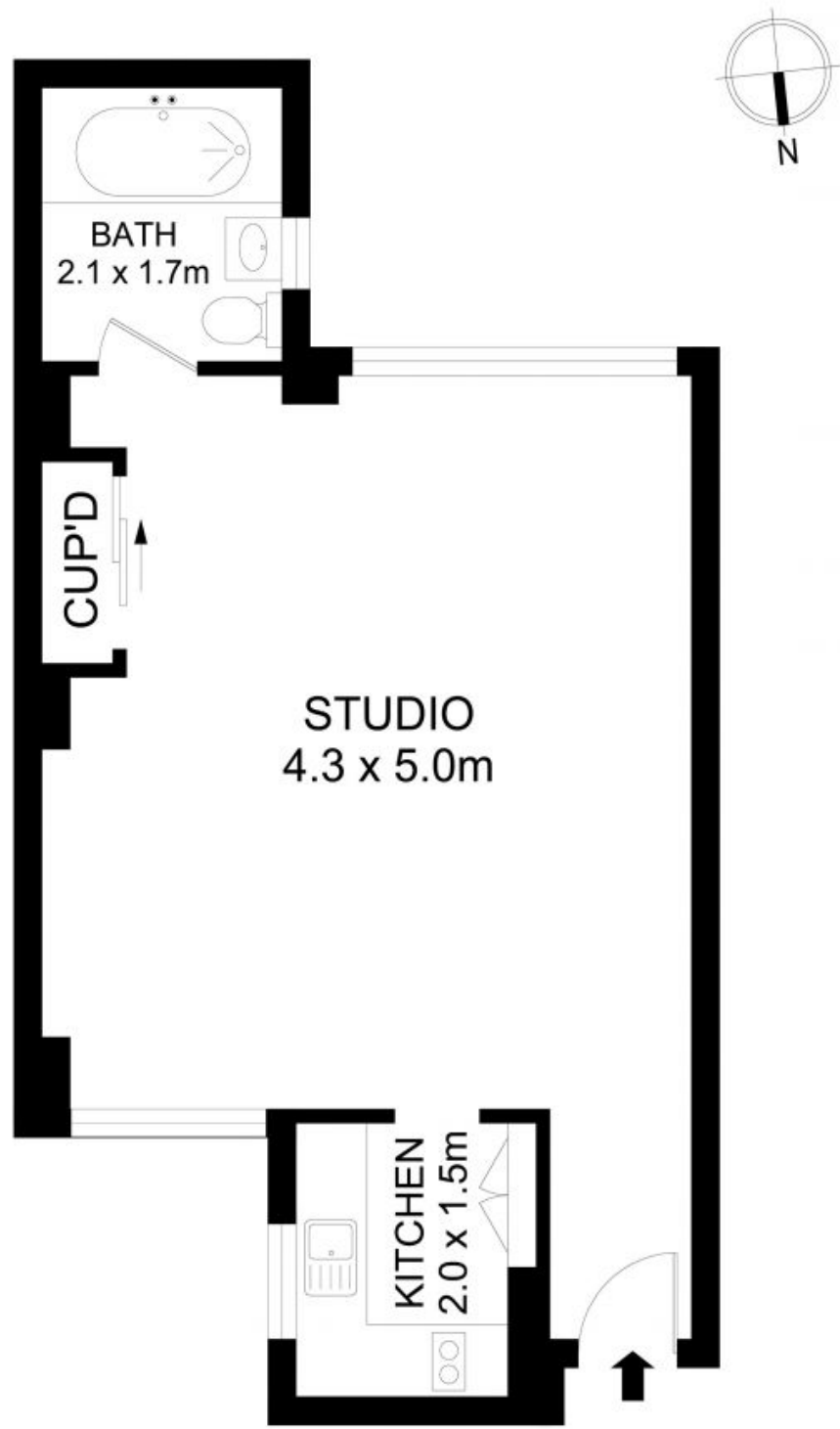

109/3-5 Greenknowe Avenue, Potts Point

Disclaimer

Floor Plan measurements are approximate and are for illustrative purposes only. While we cannot doubt the floor plans accuracy, we make no guarantee, warranty or representation as to the accuracy and completeness of the floor plan.

Every precaution has been taken to establish accuracy of the information in this brochure but does not constitute any representation by the vendor or agent.

