



1/7 Springfield Avenue Potts Point, NSW

1 bed | 1 bath

This spacious 70m² (approx.) one bedroom plus study in "Carinthia", designed by Walter Lesley Neilsen and built c1926, is set in a quiet yet private abode, in a timeless row of classic deco buildings amongst the buzz of the Potts Point village lifestyle.

- * Soaring 3m ornate ceilings throughout
- * Huge eat-in style kitchen with gas stove
- * Ample storage space throughout
- * Master bedroom with built-in cupboards

Approx Outgoings:...

R&W

rwebay.com.au/8195179

Angelo Bouras 0401 658 653

Proudly Richardson & Wrench

Richardson & Wrench Elizabeth Bay / Potts Point
02 8356 2700

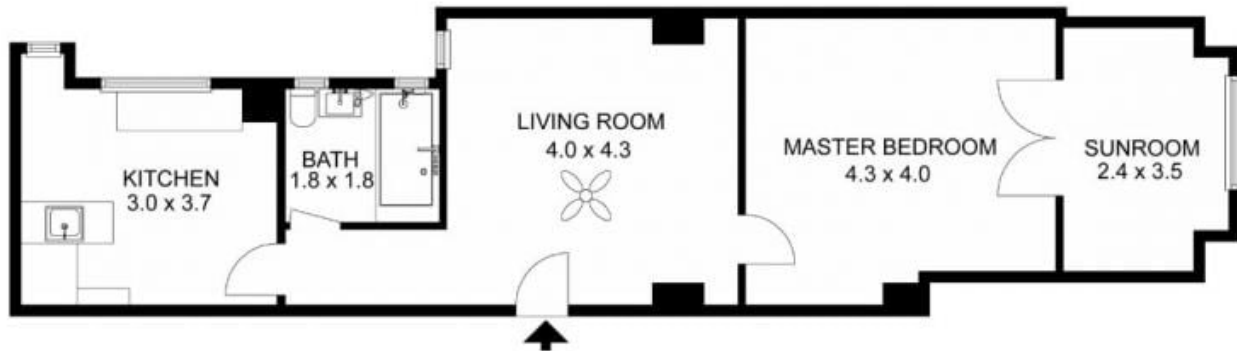

1/7 SPRINGFIELD AVENUE, POTTS POINT

The floor plan is not to scale; measurements are indicative and in metres. Exterior elements are not in position. Plans should not be relied on. Interested parties should make and rely on their own enquiries.