



45/50-58 Roslyn Gardens Elizabeth Bay, NSW

| 1 bath | 1 car



Key Features:

- .☑ Iconic building designed by the legendary Harry Seidler
- .☑ Impeccably renovated by the prestigious BKH Architects
- .☑ Peaceful and private outlook over the pool and lawn
- .☑ Access to a residents' swimming pool
- .☑ Valuable scramble parking (not on title) available on a first-in, first-served basis
- .☑ Security building in a premier Elizabeth Bay location
- .☑ Ideal for a first-home buyer, a stylish city base, or a high-end investment

...

rwebay.com.au/8478006

Penny Timothy 0418 546 500

Penny Timothy 0418 546 500

Luke McDonnell 0418 844 110

Proudly Richardson&Wrench

Richardson & Wrench Elizabeth Bay / Potts Point
02 8356 2700

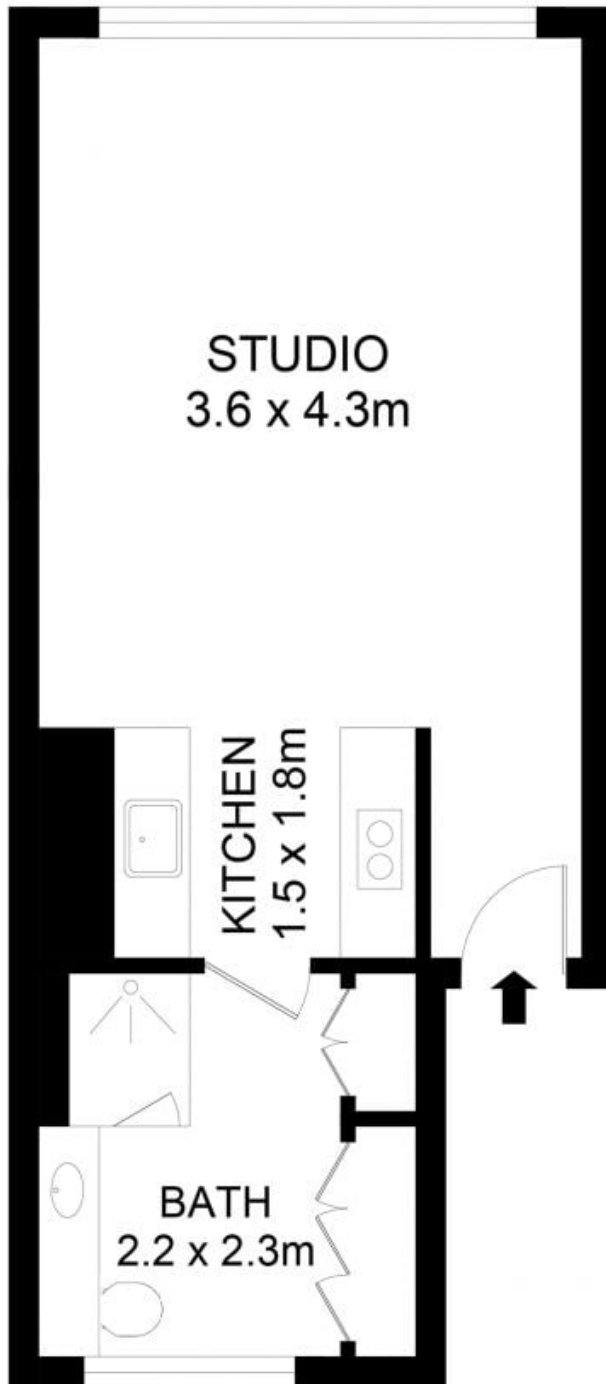
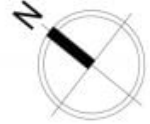

NOTE:
SCRAMBLE PARKING -
NOT ON TITLE

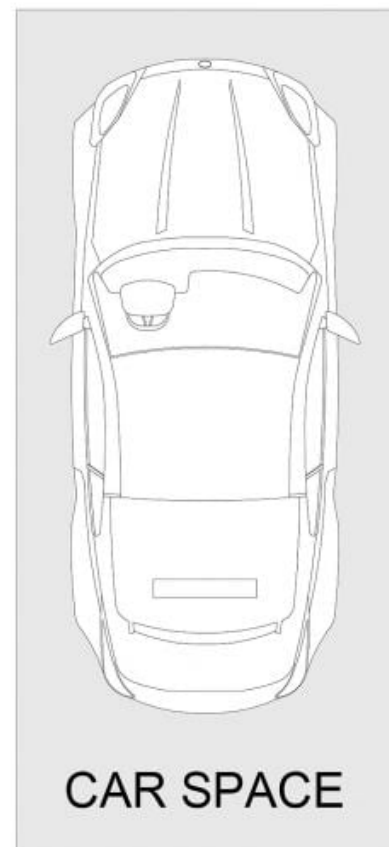

45/50-58 Roslyn Gardens, Rushcutters Bay

Disclaimer

Floor Plan measurements are approximate and are for illustrative purposes only. While we cannot doubt the floor plans accuracy, we make no guarantee, warranty or representation as to the accuracy and completeness of the floor plan

Every precaution has been taken to establish accuracy of the information in this brochure but does not constitute any representation by the vendor or agent.

R&W