



## 17b/82-94 Darlinghurst Road Potts Point, NSW

2 bed | 2 bath | 2 car

**R&W**

Positioned high within the sought-after Zenith Residences, this beautifully appointed north-facing apartment combines space, light, and spectacular city and harbour views. Offering the ultimate blend of lifestyle and convenience, it's only moments to Sydney's vibrant dining, shopping, and 90m to Kings Cross station, while enjoying the comfort of resort-style facilities.

☑️ North/west-facing with abundant natural light

Approx. Outgoings:...

**Auction Thursday, 14th May 5:30**

**R&W Offices, Shop 2/75 Macleay St, Potts Point**

Open Saturday, 18th April 2026 12:15 - 12:45

**[rwebay.com.au/8505665](https://www.rwebay.com.au/8505665)**

Angelo Bouras 0401 658 653

Alex Mulholland 0410421182

**Proudly Richardson&Wrench**

Richardson & Wrench Elizabeth Bay / Potts Point  
02 8356 2700

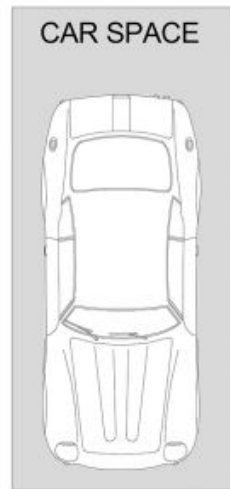
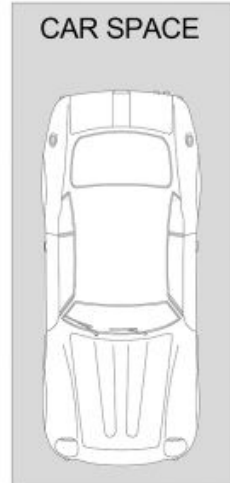
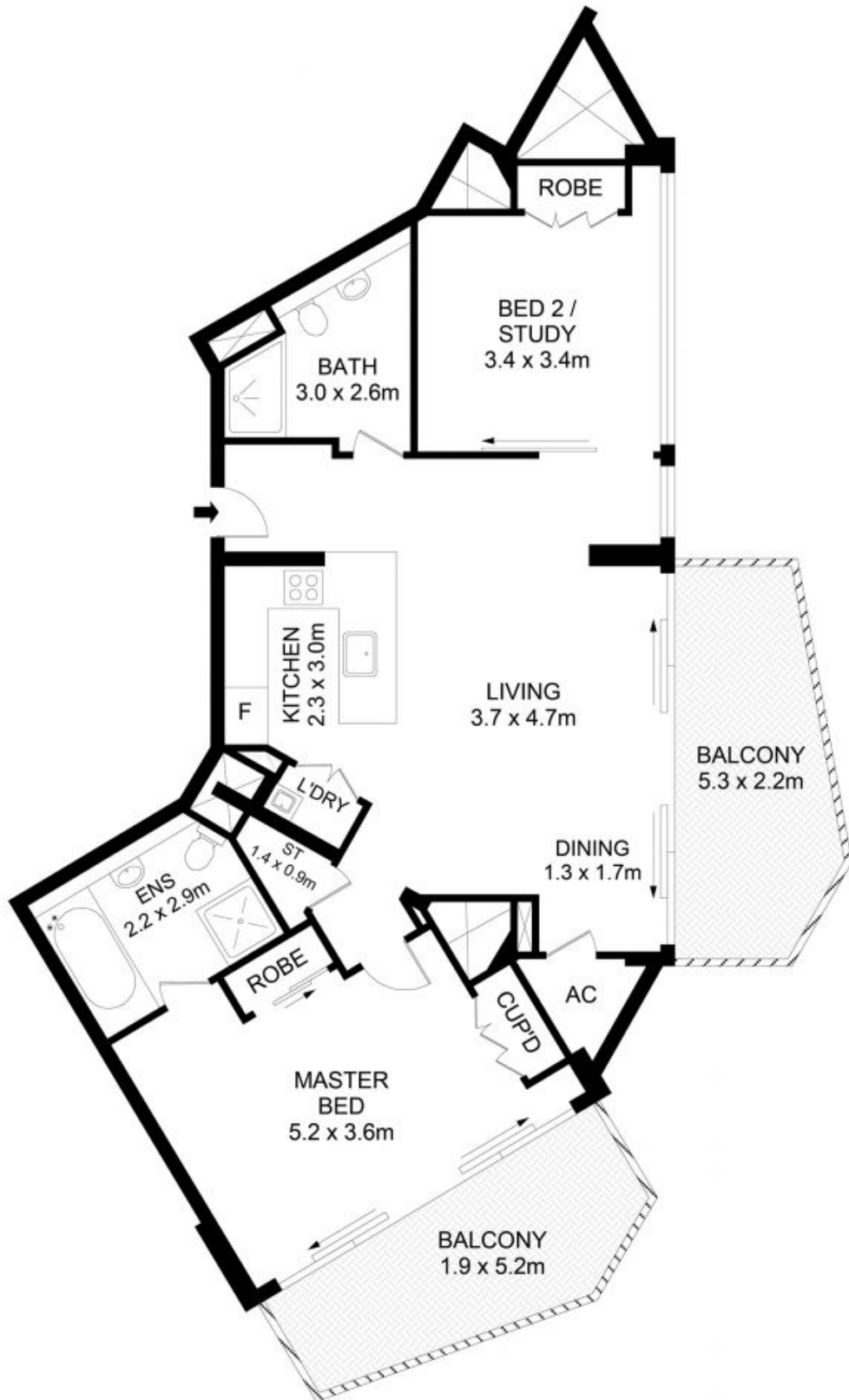

33 BAYSWATER ROAD



## 17B/82-94 Darlinghurst Road, Potts Point

**Disclaimer**  
 Floor Plan measurements are approximate and are for illustrative purposes only. While we cannot doubt the floor plans accuracy, we make no guarantee, warranty or representation as to the accuracy and completeness of the floor plan

Every precaution has been taken to establish accuracy of the information in this brochure but does not constitute any representation by the vendor or agent.

