



1104/2 Elizabeth Bay Road Elizabeth Bay, NSW

1 bed | 1 bath | 1 car

R&W

Featuring 2 private balconies and a flowing floorplan filled with N-W sunshine, this newly updated contemporary 56m² apartment offers indoor/outdoor living with stunning views from all rooms. High above the fashionable enclave, here's a sensational property to live in with lifestyle to match along with lofty views of the Harbour to Manly & CBD skyline including the Sydney Harbour Bridge. Offering creative flair, smart finishes and the quiet exclusivity of a tightly held modern landmark security tower, it's a lift ride to shops, cafes, parks, transport and cosmopolitan Macleay Street.

* Level access via impressive 2-way lobby or security p...

rwebay.com.au/8537180

Luke McDonnell 0418 844 110

Penny Timothy 0418 546 500

Proudly Richardson&Wrench

Richardson & Wrench Elizabeth Bay / Potts Point
02 8356 2700

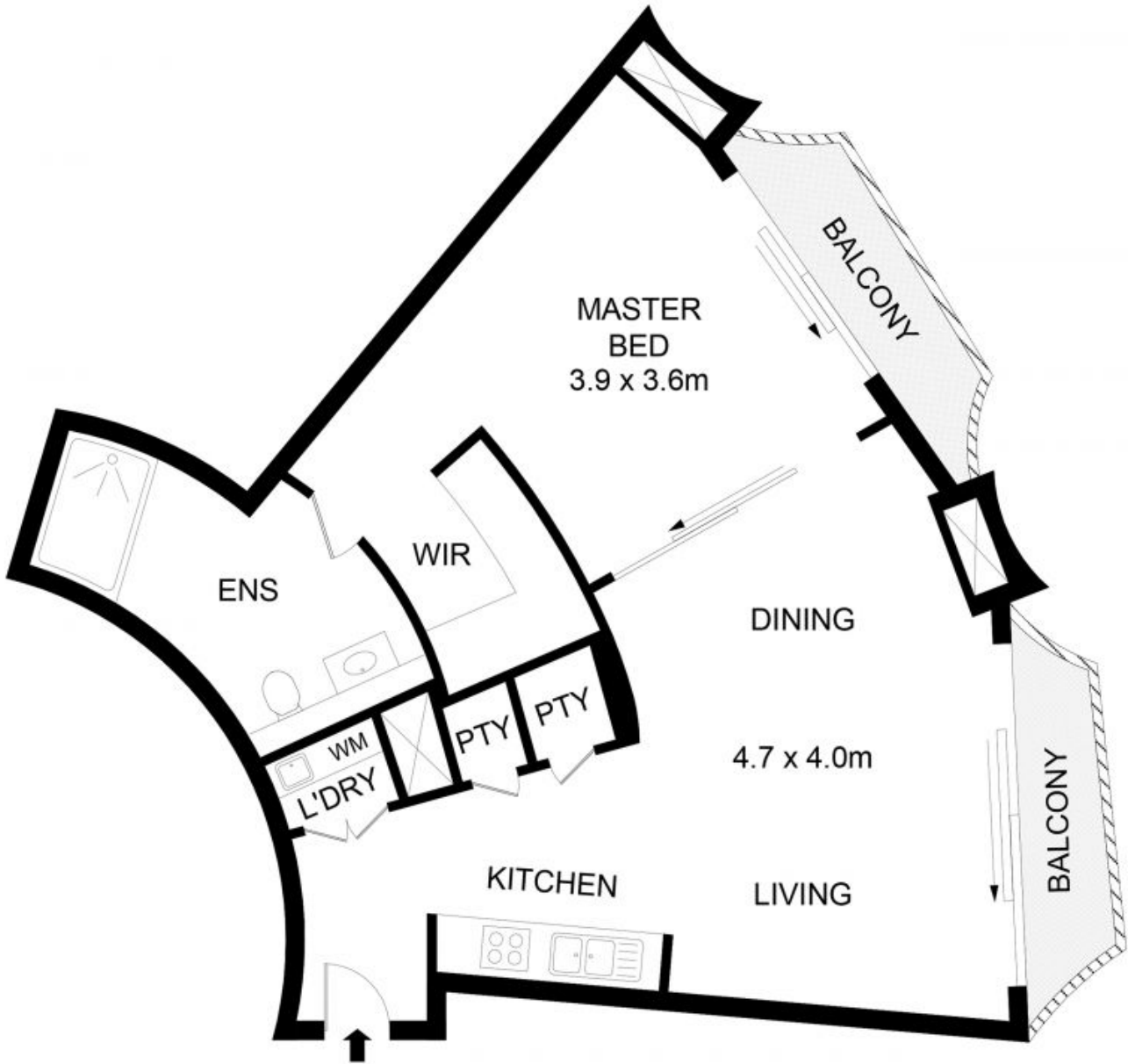

1104/2 Elizabeth Bay Road, Elizabeth Bay

Disclaimer

Floor Plan measurements are approximate and are for illustrative purposes only. While we cannot doubt the floor plans accuracy, we make no guarantee, warranty or representation as to the accuracy and completeness of the floor plan.