



## 303/63 Crown Street Woolloomooloo, NSW

2 bed | 2 bath | 1 car

Bathed in abundant natural light, this north-facing two-bedroom, two-bathroom residence within the prestigious Crown Gardens offers a rare blend of luxury, privacy, and convenience. Showcasing sweeping views of St Mary's Cathedral and the glittering CBD skyline, this home delivers the ease of single-level apartment living with an impressive 121sqm of internal space, plus 15sqm secure parking and 2sqm storage.

Positioned on the desirable north-west corner, the apar...

# R&W

[Opibay.com.au/8539558](https://www.opibay.com.au/8539558)

Geoff Cox 0418 231 004

Jason Boon 0418 671 494

Joss Reid 0414 662 391

**Proudly Richardson&Wrench**

Richardson & Wrench Elizabeth Bay / Potts Point  
02 8356 2700

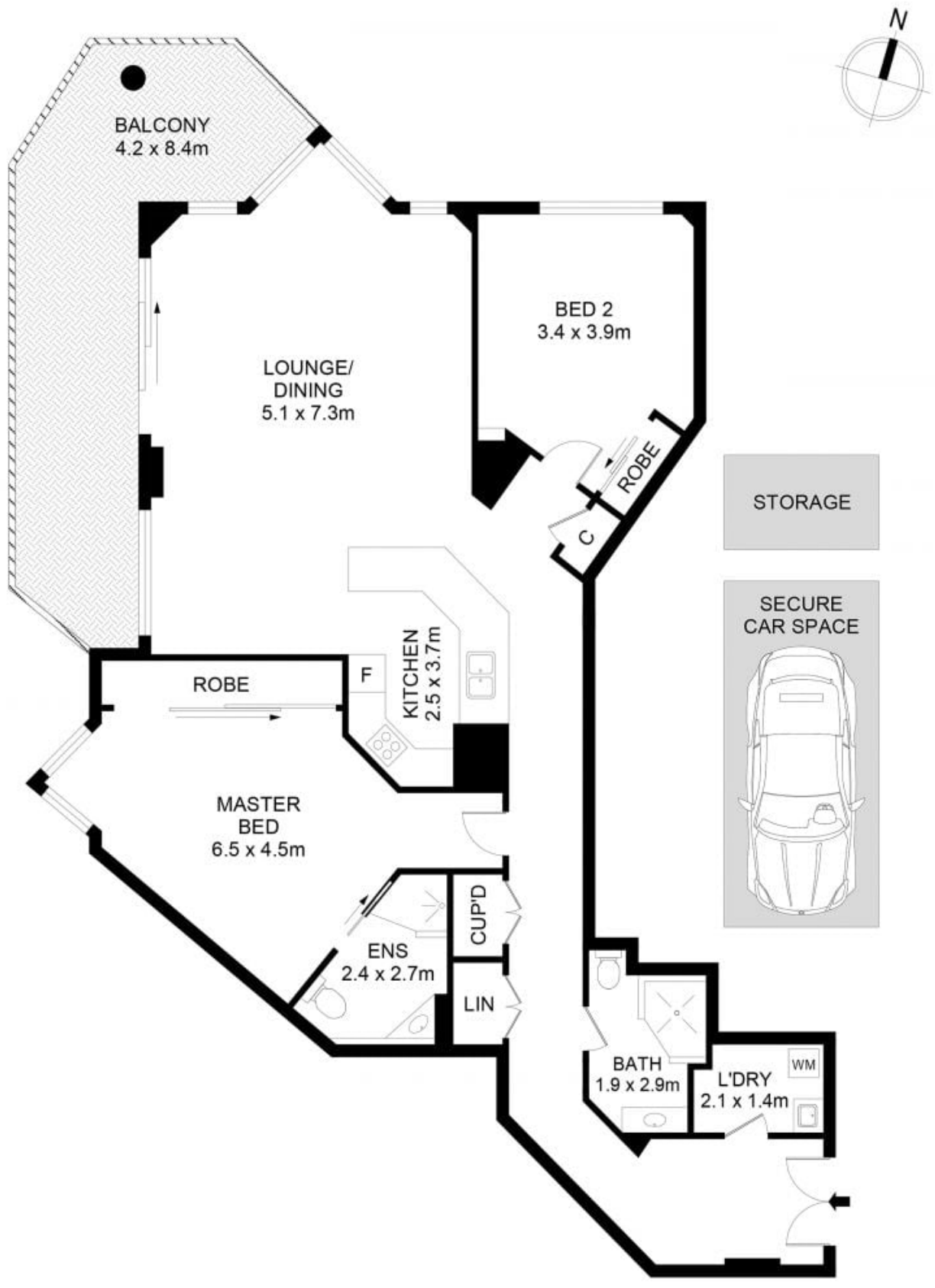

## 303/63 Crown Street, Woolloomooloo

**Disclaimer**  
 Floor Plan measurements are approximate and are for illustrative purposes only. While we cannot doubt the floor plans accuracy, we make no guarantee, warranty or representation as to the accuracy and completeness of the floor plan.

Every precaution has been taken to establish accuracy of the information in this brochure but does not constitute any representation by the vendor or agent.

