



1/244-246 William Street Potts Point, NSW

1 bed | 1 bath

R&W

If you are longing to live in the heart of the action, this easy living one bedroom apartment provides a bevy of attractions right on your doorstep. Conveniently located at the junction of Potts Point and Darlinghurst, you are only a stroll to everything popular in this locale: restaurants, cafes, shopping, transport, bars, clubs & the CBD. With oodles of built-in storage throughout, this well planned and fluid apartment with a practical study nook and balcony dining makes valuable use of every 50m². The proximity to literally everything will always make this apartment a smart investment.

- Secure building, intercom and lift access; air con & ...

rwebay.com.au/8542927

Joss Reid 0414 662 391

Jason Boon 0418 671 494

Geoff Cox 0418 231 004

Proudly Richardson & Wrench

Richardson & Wrench Elizabeth Bay / Potts Point
02 8356 2700

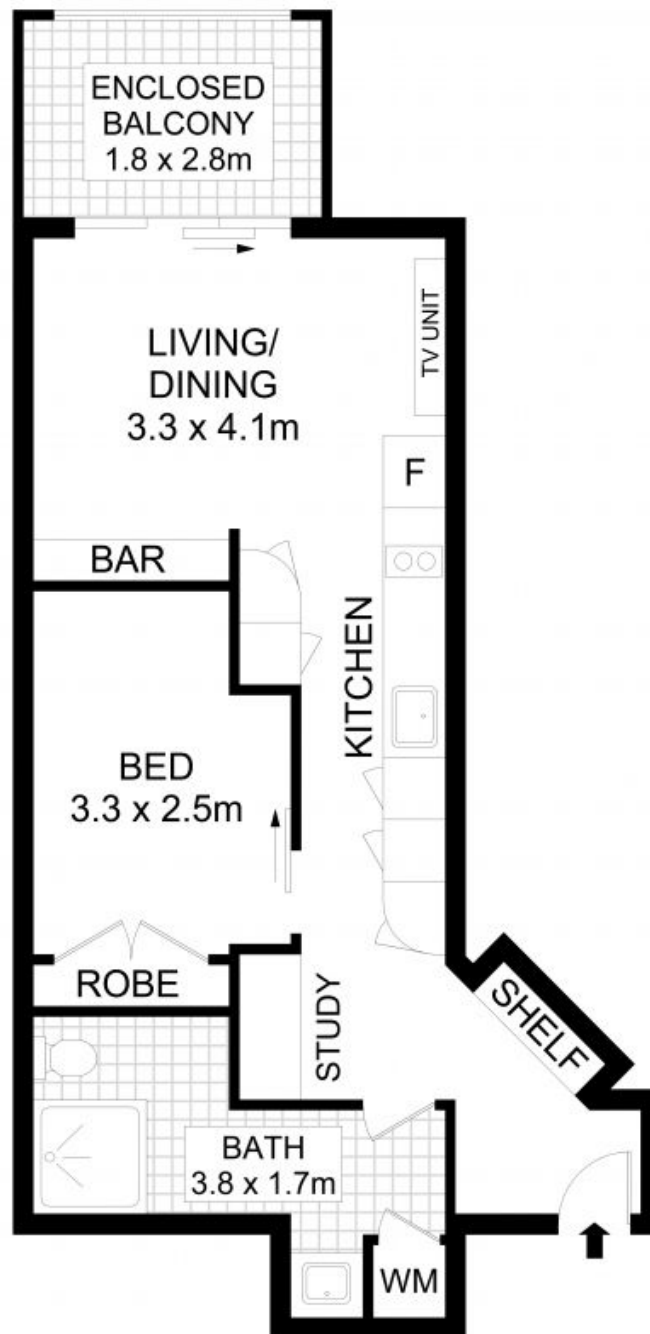
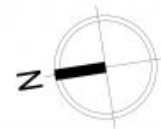

1/246 William Street, Potts Point 0 1 2 5

Disclaimer

Floor Plan measurements are approximate and are for illustrative purposes only. While we cannot doubt the floor plans accuracy, we make no guarantee, warranty or representation as to the accuracy and completeness of the floor plan

Every precaution has been taken to establish accuracy of the information in this brochure but does not constitute any representation by the vendor or agent.

R&W