

12/12 Springfield Avenue Potts Point, NSW

2 bed | 1 bath

R&W

Set within a boutique security building of just twelve residences, this expansive dual-level two-bedroom apartment delivers exceptional space, natural light and lifestyle appeal in the heart of Potts Point village. Spanning an impressive 105sqm, the home enjoys a thoughtful layout with excellent separation between living and accommodation, offering comfort, privacy and outstanding potential to personalise.

The oversized living and dining zone flows seamlessly t...

rwebay.com.au/8624736

Angelo Bouras 0401 658 653

Alex Mulholland 0410421182

Proudly Richardson&Wrench

Richardson & Wrench Elizabeth Bay / Potts Point
02 8356 2700

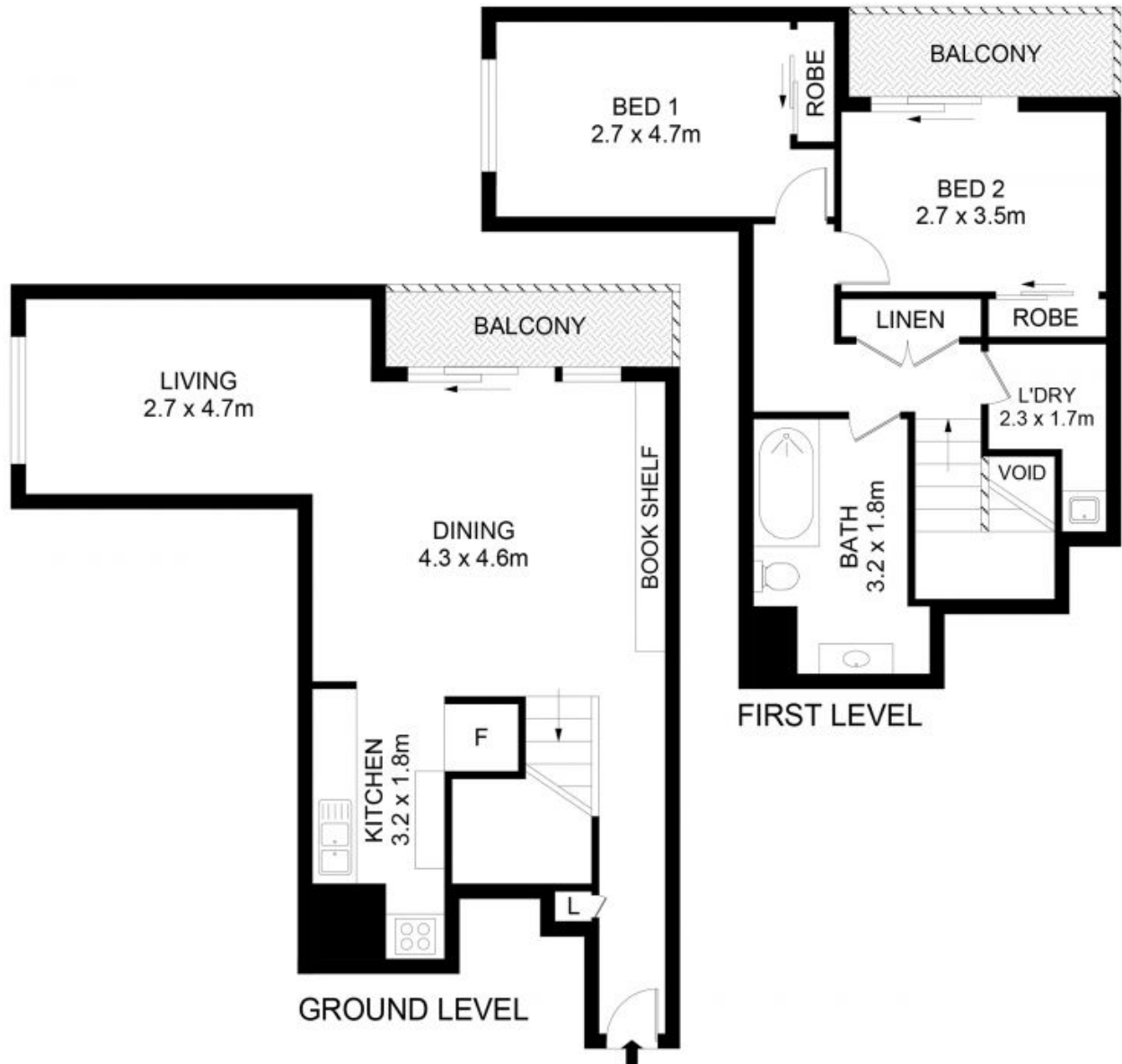

12/12 Springfield Avenue, Potts Point



Disclaimer

Floor Plan measurements are approximate and are for illustrative purposes only. While we cannot doubt the floor plans accuracy, we make no guarantee, warranty or representation as to the accuracy and completeness of the floor plan.